

ORDINANCE 17-09

**AN ORDINANCE OF THE CITY OF BLOOMINGTON,
MONROE COUNTY, INDIANA, ANNEXING TERRITORY TO THE
CITY OF BLOOMINGTON, PLACING THE SAME WITHIN THE CORPORATE
BOUNDARIES THEREOF, AND MAKING THE SAME A PART OF
THE CITY OF BLOOMINGTON**

South-West A Bloomington Annexation

- WHEREAS, the City of Bloomington (“City”) has studied the City’s municipal boundaries, areas historically identified for annexation or urbanization, surrounding developed territory, provisions of local government service, agreements for annexation in exchange for City services, and opportunities for growth and development of the City and its surrounding community; and
- WHEREAS, the City has identified several areas outside of the City’s current municipal boundaries that are appropriate for annexation to the City, and has determined to proceed through the introduction and consideration of separate ordinances for the several areas, of which the “South-West A Bloomington Annexation Area” set forth in this Ordinance is one; and
- WHEREAS, prior to the introduction of annexation ordinances, the City has provided notice to landowners and conducted an outreach program to inform citizens regarding the then-proposed annexations, actively investigated the proposed annexations, and conducted numerous meetings with local residents, businesses, and entities in an effort to develop annexations that include terms that are fair and equitable to the property owners and residents of the City and the annexation areas; and
- WHEREAS, a map and legal description of the “South-West A Bloomington Annexation Area” (“Annexation Territory”) are attached hereto as Exhibit A and Exhibit B, respectively; and
- WHEREAS, the Annexation Territory consists of approximately 3,162.54 acres, and is contiguous to the existing City limits; and
- WHEREAS, the City has engaged professionals to study the fiscal and governmental impacts of the annexation on the City and on affected landowners and taxing units; and
- WHEREAS, the City recognizes and accepts its obligations, where applicable, pursuant to I.C. §§ 36-4-3-7 and 36-4-3-10; and
- WHEREAS, prior to adoption of this Ordinance, the City, by resolution, has adopted a written fiscal plan and policy for the provision of services of both a non-capital and capital nature to the Annexation Territory, including cost estimates and financing, and the estimated effect on taxpayers, municipal finances, and other political subdivisions, that meet the requirements of I.C. § 36-4-3; and
- WHEREAS, the terms and conditions of this annexation, including the written fiscal plan and policy, are fairly calculated to make the annexation fair and equitable to property owners and residents of the Annexation Territory and of the City; and
- WHEREAS, the City has further determined the Annexation Territory is needed and can be used by the City of Bloomington for its development in the reasonably near future; and
- WHEREAS, prior to the final adoption of this Ordinance, the City has conducted a public hearing pursuant to proper notice; and

WHEREAS, it is the determination of the Common Council that the annexation set forth herein is appropriate and the Annexation Territory should be annexed to the City of Bloomington pursuant to the terms of this Ordinance.

NOW, THEREFORE, BE IT ORDAINED BY THE COMMON COUNCIL OF THE CITY OF BLOOMINGTON, MONROE COUNTY, INDIANA, THAT:

SECTION 1. The above recitals are incorporated herein by this reference as though fully set forth herein below. In accordance with I.C. § 36-1-5-4 two copies of the recitals are on file in the office of the city clerk for public inspection.

SECTION 2. In accordance with I.C. § 36-4-3 et seq., the Annexation Territory described and depicted in Exhibit A and Exhibit B is hereby annexed to the City and thereby included within its corporate boundaries pursuant to the terms of this Ordinance.

SECTION 3. The City will be responsible for local right-of-way contiguous to the Annexation Territory. As set forth in I.C. § 36-4-3-2.5, where the legal description attached as Exhibit B describes land that is contiguous to a public highway right-of-way that has not previously been annexed and is not within another municipality as of the effective date hereof, the Annexation Territory shall include the contiguous public highway right-of-way even if it is not described in Exhibit B.

SECTION 4. Notwithstanding any discrepancies, errors, or omissions in the legal descriptions of prior annexation ordinances or this Ordinance, it is the intent of the City that where a parcel of property within the Annexation Territory is adjacent to a parcel of property within the existing City limits, the Annexation Territory boundary shall conform to and match the boundary of the existing City boundaries so long as this does not result in adding or removing parcels of property from the Annexation Territory depicted in the map attached as Exhibit A.

SECTION 5. As authorized by I.C. § 36-4-3-8(b)(1), the effective date of this annexation is postponed such that the Annexation Territory shall be a part of the City as of the January 1, 2024 assessment date (i.e. effective immediately prior to January 1, 2024).

SECTION 6. As provided in I.C. § 36-4-3-4.1, any real property in the Annexation Territory assessed as agricultural land (under the real property assessment rules and guidelines of the department of local government finance) is exempt from property tax liability under I.C. § 6-1.1 for municipal purposes, and is not considered a part of the City for purposes of annexing future additional territory, while the property's assessment classification remains agricultural land.

SECTION 7. The Annexation Territory is assigned to Council District No. 2. The City recognizes its redistricting responsibilities under I.C. § 36-4-6-3(g)(1) (following the 2020 census) and I.C. § 36-4-6-3(g)(2) (following annexation). Following the effective date of the annexations, whether in conjunction with the post-census redistricting or as an additional redistricting, the City will review and redistrict its Council Districts as appropriate and required to ensure compliance with I.C. § 36-4-6-3(j) or other applicable laws.

SECTION 8. There is hereby created a special fund titled the "South-West A Bloomington Annexation Impoundment Fund" ("Impoundment Fund"). For a period of three (3) years following the effective date of this annexation, all municipal property taxes imposed in the Annexation Territory after the annexation takes effect that are not used to meet the basic non-capital and capital services set forth in the fiscal plan shall be impounded in the Impoundment Fund. The impounded property taxes in the Fund shall be used to provide additional services that were not specified in the fiscal plan, and shall be expended not later than five (5) years after the annexation becomes effective.

SECTION 9. There is hereby created an advisory board titled the "South-West A Bloomington Annexation Advisory Board" ("Advisory Board"). The Advisory Board is governed by I.C. § 36-4-3-8.1, and shall advise the City on the provision of services to the Annexation Territory that are paid for with the municipal property taxes impounded in the Impoundment Fund. The Advisory

Board shall be appointed not later than ninety (90) days after the annexation becomes effective, and shall consist of the following seven (7) members:

- (1) The township trustee of the township with the largest number of residents living within the Annexation Territory;
- (2) One (1) member of the County Council representing the district with the largest number of residents living within the Annexation Territory;
- (3) One (1) member who is the City engineer (or, a licensed professional engineer appointed by the Mayor if the City does not have a municipal engineer);
- (4) Two (2) citizen members, appointed by the Mayor, who own real property and reside within the Annexation Territory;
- (5) Two (2) citizen members, appointed by the County Commissioners, who own real property and reside within the Annexation Territory.

SECTION 10. The Annexation Territory shall maintain its current zoning classification(s) and designation(s) until such time as the City updates its respective comprehensive plan, zoning ordinance, or zoning map.

SECTION 11. All prior Ordinances or parts thereof that may be inconsistent with any provision of this Ordinance are hereby superseded. The paragraphs, sentences, words, and Annexation Territory of this Ordinance are separable, and if a court of competent jurisdiction hereof declares any portion of this Ordinance or the Annexation Territory unconstitutional, invalid, or unenforceable for any reason, such declaration shall not affect the remaining portions of the Annexation Territory or this Ordinance.

SECTION 12. The effective date of this annexation shall be as soon as allowed by law following its adoption, execution, and publication as required by law, except as otherwise set forth above.

INTRODUCED on March 29, 2017, and passed by the Common Council of the City of Bloomington, Monroe County, Indiana, on this 15 day of September, 2021.¹

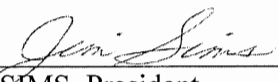

JIM SIMS, President
Bloomington Common Council

ATTEST:

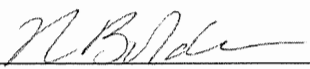

NICOLE BOLDEN, Clerk
City of Bloomington

¹ I affirm, under the penalties for perjury, that I have taken reasonable care to redact each Social Security number in this document, unless required by law. Stephen C. Unger

This Ordinance was prepared by Stephen C. Unger, Attorney At Law, Bose McKinney & Evans LLP, 111 Monument Circle, Suite 2700, Indianapolis, Indiana 46204.

PRESENTED by me to the Mayor of the City of Bloomington, Monroe County, Indiana, upon this
17 day of September, 2021.

ATTEST:

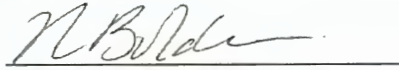

NICOLE BOLDEN, Clerk
City of Bloomington

SIGNED and APPROVED by me upon this 20th day of September, 2021.

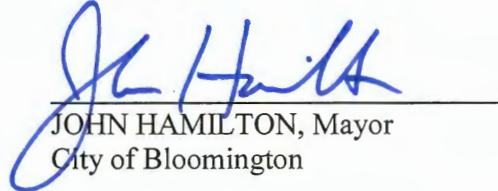

JOHN HAMILTON, Mayor
City of Bloomington

Synopsis

Upon adoption, this ordinance would take various steps necessary for the annexation of the South-West A Bloomington Annexation area, which is depicted in Exhibit A and attached to this ordinance. In the course of proposing the annexation of this area, the City prepared a written Fiscal Plan for Municipal Annexation ("Fiscal Plan") that describes the proposed provision of both non-capital and capital services to the Annexation Territory and was initially adopted via Resolution 17-16 and amended via Resolution 21-09. The approval of a further amendment to the written Fiscal Plan is scheduled for consideration at a Common Council Session on September 15, 2021, when the Common Council will consider adoption of the proposed annexation.

Note on amendments, which have been incorporated into Ordinance 17-09:

At the May 19, 2021 Regular Session, the Council adopted Amendment 01 to Ordinance 17-09, which updated the map (Exhibit A) and legal description (Exhibit B) for South-West A Bloomington Annexation Area and also changed various date references and signature lines to bring the proposed ordinance forward to 2021 so that it could be properly considered by the Common Council.

At the August 31, 2021 Special Session, the Council adopted Amendment 02 to Ordinance 17-09, which added an impoundment fund and corresponding advisory board for South-West A Bloomington Annexation Area.

At the September 15, 2021 Special Session, the Council adopted Amendment 03 to Ordinance 17-09, which removed one additional parcel subject to a payment in lieu of annexation agreement and updated the acreage total.

Distributed to: Clerk, Council Attorney, Legal, Mayor, Controller

Exhibit A

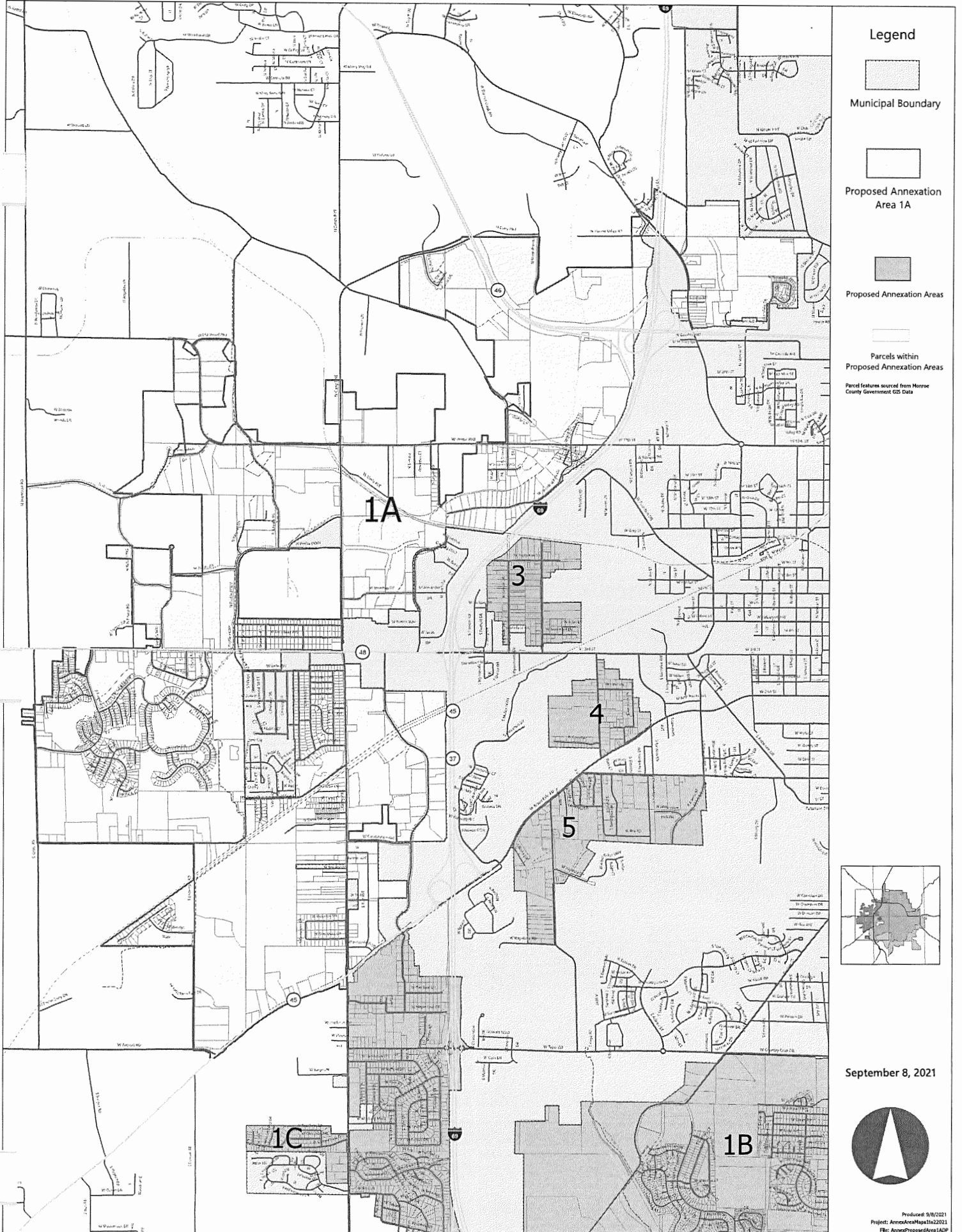

Controller's
Office
**City of
Bloomington**



Proposed Annexation Areas
Area 1A - South-West Bloomington (A)

This map was produced by the City of Bloomington GIS, for use by the City and general public as map information. The planimetric information is based on aerial orthorectified flown in March 2016. Supplemental updates are made from development drawings, plats, and other sources. The accuracy of information contained in this document is based on National Mapping Standards, however it is NOT warranted. The Corporation boundary reflects annexations effective as of the print date on this map.

1,100 550 0 1,100 2,200 3,300 4,400 5,500
Feet

No part of this work may be reproduced for any purpose without written permission from the City of Bloomington

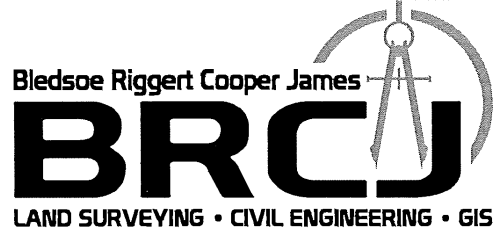

ANNEXATION STUDY AREA 1A (2017) EXHIBIT

A part of Sections 20, 29, 30 and 31, Township 9 North, Range 1
 West, Sections 25, 26, 35 and 36, Township 9 North, Range 2
 West, Sections 1, 2, 3, 11, 12 and 14, Township 8 North, Range 2
 West, Monroe County, Indiana

SECTION LINE PER GIS
 ANNEXATION STUDY AREA
 EXISTING CITY OF BLOOMINGTON BOUNDARY

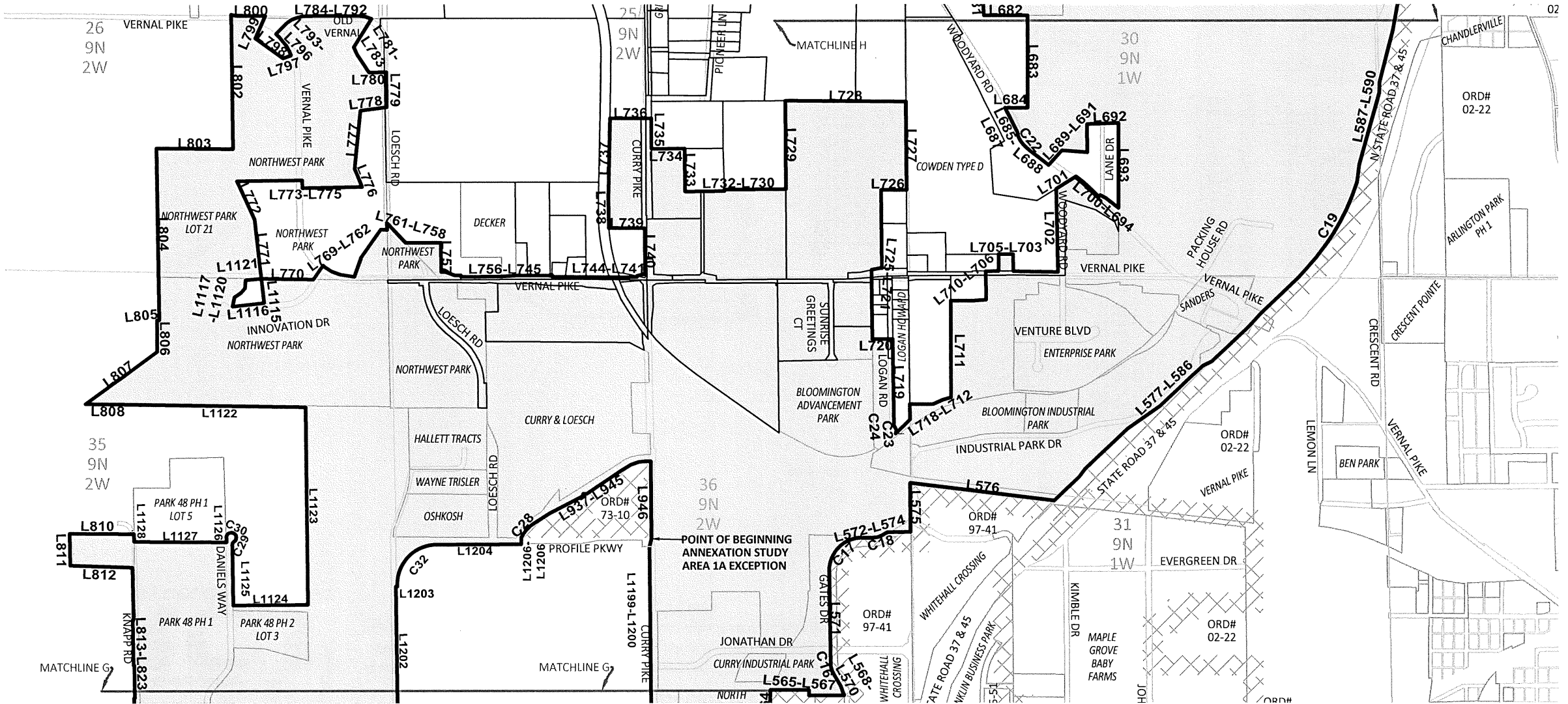
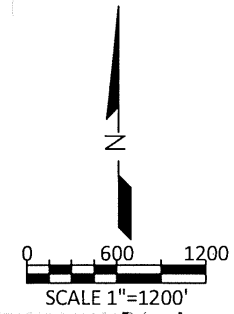

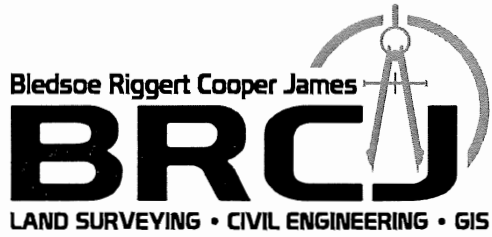

Bloomington • Bedford • Paoli



ANNEXATION STUDY AREA 1A (2017) EXHIBIT

A part of Sections 20, 29, 30 and 31, Township 9 North, Range 1 West, Sections 25, 26, 35 and 36, Township 9 North, Range 2 West, Sections 1, 2, 3, 11, 12 and 14, Township 8 North, Range 2 West, Monroe County, Indiana

-  SECTION LINE PER GIS
-  ANNEXATION STUDY AREA
-  EXISTING CITY OF BLOOMINGTON BOUNDARY

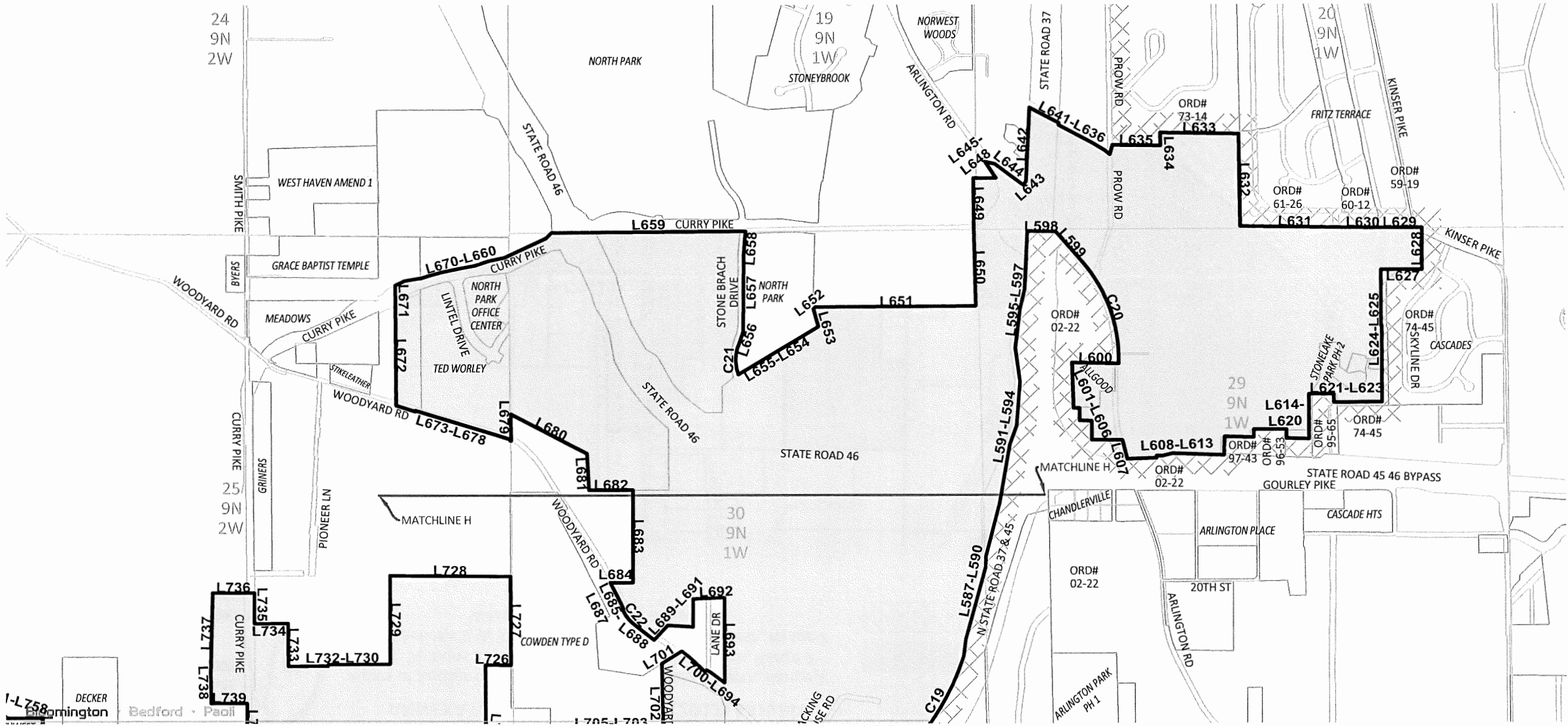
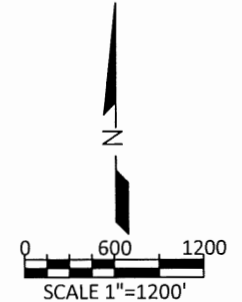



ANNEXATION STUDY AREA 1A (2017) EXHIBIT

A part of Sections 20, 29, 30 and 31, Township 9 North, Range 1 West, Sections 25, 26, 35 and 36, Township 9 North, Range 2 West, Sections 1, 2, 3, 11, 12 and 14, Township 8 North, Range 2 West, Monroe County, Indiana

AREA 1A LINE TABLE			AREA 1A LINE TABLE			AREA 1A LINE TABLE		
L522	N 34°04'14" W	354.36'	L610	S 87°50'00" E	57.85'	L698	N 47°37'45" W	62.99'
L523	N 00°35'45" E	806.57'	L611	N 75°28'03" E	104.40'	L699	N 50°38'22" W	51.67'
L524	N 88°14'55" E	777.49'	L612	S 87°50'00" E	532.90'	L700	N 54°51'22" W	42.87'
L525	N 00°10'19" W	261.27'	L613	N 01°46'04" E	189.49'	L701	S 58°03'24" W	237.38'
L526	S 89°28'58" W	745.08'	L614	S 88°30'19" E	300.00'	L702	S 01°09'55" E	853.05'
L527	N 00°29'53" E	1037.10'	L615	N 00°00'00" W	80.93'	L703	N 89°05'20" W	459.81'
L528	S 89°04'50" E	45.94'	L616	N 89°59'56" E	165.85'	L704	N 00°28'04" W	175.29'
L620	S 78°55'42" E	428.10'	L617	N 89°59'56" E	165.84'	L705	S 89°47'31" W	150.00'
L530	N 89°28'06" E	1265.82'	L618	S 00°23'46" E	90.37'	L706	S 00°18'13" E	171.64'
L531	N 00°01'15" E	1194.02'	L619	S 88°30'19" E	231.98'	L707	S 89°25'20" W	131.83'
L532	N 04°32'45" W	99.91'	L620	N 00°00'00" W	455.22'	L708	S 00°02'11" E	292.75'
L533	N 00°36'29" W	250.22'	L621	N 90°00'00" E	252.20'	L709	S 86°41'15" W	126.61'
L534	N 01°44'18" W	1249.31'	L622	S 01°45'33" E	82.77'	L710	S 89°48'50" W	232.97'
L535	N 11°49'32" W	102.27'	L623	N 89°58'42" E	492.32'	L711	S 00°00'01" E	985.47'
L536	N 07°24'46" E	151.87'	L624	N 00°00'00" W	780.20'	L712	S 73°00'56" W	90.59'
L537	N 06°06'54" E	405.76'	L625	N 90°00'00" W	8.25'	L713	S 67°19'36" W	91.71'
L538	N 01°05'04" E	378.82'	L626	N 00°00'00" W	572.00'	L714	S 60°44'49" W	16.62'
L539	N 89°28'49" W	1449.25'	L627	N 90°00'00" E	419.00'	L715	S 89°59'58" W	239.68'
L540	N 90°00'00" W	102.90'	L628	N 00°00'00" W	431.13'	L716	S 00°28'16" E	159.07'
L541	N 00°00'00" W	42.00'	L629	S 89°53'05" W	452.31'	L717	S 45°53'31" W	200.52'
L542	N 90°00'00" W	668.00'	L630	N 89°26'28" W	300.00'	L718	N 45°31'45" W	12.49'
L543	N 00°00'00" W	619.00'	L631	N 89°19'06" W	1106.13'	L719	N 00°37'35" W	887.80'
L544	S 88°23'44" W	1303.67'	L632	N 00°35'36" W	943.94'	L720	S 89°11'57" W	211.49'
L545	S 00°02'00" E	130.00'	L633	N 89°10'26" W	804.71'	L721	N 00°28'16" W	611.45'
L546	S 89°11'00" W	417.00'	L634	S 00°35'36" E	132.00'	L722	N 00°28'16" W	96.25'
L547	S 00°09'08" W	1800.28'	L635	N 89°10'36" W	493.66'	L723	N 78°19'48" E	79.91'
L548	S 89°00'00" E	82.45'	L636	S 16°14'17" W	97.86'	L724	S 89°50'43" E	28.17'
L549	S 01°17'24" W	1446.48'	L637	N 51°26'13" W	72.76'	L725	N 00°27'41" W	800.77'
L550	S 88°10'56" W	1235.99'	L638	N 58°51'30" W	134.84'	L726	S 89°35'25" E	259.76'
L551	N 01°01'03" W	1504.25'	L639	N 62°22'40" W	398.78'	L727	N 00°18'12" W	903.90'
L552	N 01°25'16" W	1779.71'	L640	N 13°39'36" E	22.71'	L728	N 89°35'51" W	1234.57'
L553	N 89°38'00" E	810.25'	L641	N 62°19'32" W	335.37'	L729	S 00°17'18" E	900.76'
L554	N 89°24'29" E	154.84'	L642	S 02°50'09" W	758.29'	L730	S 89°46'40" W	633.15'
L555	N 00°02'35" W	500.23'	L643	S 49°16'10" W	43.81'	L731	S 01°24'06" E	16.86'
L556	N 89°59'48" E	1596.10'	L644	N 53°05'40" W	355.53'	L732	S 89°26'10" W	404.70'
L557	N 01°34'00" W	211.27'	L645	N 78°50'44" W	100.87'	L733	N 00°24'33" W	438.51'
L558	N 00°00'00" W	623.27'	L646	S 32°53'05" E	172.00'	L734	S 89°38'03" W	341.01'
L559	N 90°00'00" E	733.00'	L647	S 41°12'19" E	27.05'	L735	N 00°02'54" W	311.65'
L560	S 00°00'00" E	76.75'	L648	S 89°59'58" W	233.25'	L736	S 89°59'13" W	426.11'
L561	N 90°00'00" E	90.00'	L649	S 00°14'43" E	524.48'	L737	S 01°17'49" W	815.90'
L562	S 00°00'00" E	64.00'	L650	S 01°26'13" E	782.31'	L738	S 00°57'51" E	307.76'
L563	N 90°00'00" E	340.00'	L651	S 89°41'55" W	1641.28'	L739	N 89°59'58" E	366.88'
L564	N 01°19'09" E	383.01'	L652	S 50°53'44" W	30.35'	L740	S 00°13'20" E	471.56'
L565	N 90°00'00" E	394.87'	L653	S 15°14'21" E	187.79'	L741	N 87°25'16" W	29.97'
L566	S 00°00'00" E	55.72'	L654	S 59°13'56" W	951.39'	L742	S 73°27'14" W	50.89'
L567	N 90°00'00" E	358.84'	L655	N 14°21'36" W	31.80'	L743	S 00°00'20" W	15.14'
L568	N 17°55'33" W	73.05'	L656	N 18°27'04" E	158.30'	L744	N 89°42'37" W	866.49'
L569	N 25°05'36" W	28.61'	L657	N 00°25'00" E	781.92'	L745	N 00°19'32" E	18.40'
L570	N 30°03'59" W	142.25'	L658	N 04°30'22" E	241.16'	L746	N 87°37'37" W	21.42'
L571	N 00°40'46" W	962.35'	L659	S 89°36'46" W	1980.28'	L747	S 00°15'20" E	8.09'
L572	N 89°59'28" E	121.88'	L660	S 46°00'12" W	78.78'	L748	N 87°37'36" W	28.38'
L573	N 59°10'11" E	63.98'	L661	S 65°03'54" W	469.14'	L749	S 89°56'51" W	310.22'
L574	N 89°26'53" E	240.86'	L662	S 77°51'26" W	155.41'	L750	S 87°03'20" W	99.85'
L575	N 00°33'07" W	500.00'	L663	S 71°43'01" W	165.56'	L751	S 85°04'20" W	63.38'
L576	S 83°04'10" E	1493.24'	L664	S 80°03'03" W	170.24'	L752	S 89°53'16" W	416.00'
L577	N 47°00'27" E	355.25'	L665	S 78°15'22" W	166.07'	L753	N 00°04'27" W	13.85'
L578	N 35°41'54" E	101.98'	L666	S 74°34'23" W	135.89'	L754	S 89°39'00" W	63.19'
L579	N 47°00'30" E	600.00'	L667	S 73°31'13" W	97.23'	L755	N 69°21'00" W	96.57'
L580	N 55°32'21" E	404.48'	L668	N 00°09'10" W	1.80'	L756	N 89°47'23" W	49.80'
L581	N 47°00'30" E	600.00'	L669	S 80°12'12" W	163.94'	L757	N 00°24'37" W	300.22'
L582	N 63°42'27" E	104.40'	L670	S 64°39'24" W	104.13'	L758	S 89°52'16" W	362.96'
L583	N 47°00'30" E	500.00'	L671	S 00°33'59" E	207.27'	L759	N 42°58'01" W	276.48'
L584	N 42°43'09" E	200.56'	L672	S 00°33'59" E	1020.76'	L760	S 00°47'37" E	72.32'
L585	N 46°35'12" E	508.64'	L673	S 72°39'11" E	204.92'	L761	N 86°50'30" W	65.44'
L586	N 42°30'26" E	142.94'	L674	N 03°41'18" E	9.76'	L762	S 35°43'10" W	347.45'
L587	N 07°50'47" E	180.80'	L675	S 73°19'02" E	875.19'	L763	S 19°18'43" W	210.04'
L588	N 15°30'30" E	759.25'	L676	S 72°12'55" E	134.90'	L764	N 81°10'06" W	145.16'
L589	N 01°28'20" E	103.08'	L677	S 01°49'23" E	11.57'	L765	N 69°18'34" W	96.34'
L590	N 14°27'41" E	558.98'	L678	S 65°10'17" E	15.00'	L766	N 57°43'53" W	53.61'
L591	N 10°08'30" E	615.10'	L679	N 00°13'52" W	274.25'	L767	N 57°43'52" W	38.30'
L592	N 19°58'48" E	200.72'	L680	S 62°29'16" E	871.52'	L768	N 47°07'45" W	14.32'
L593	N 04°33'21" E	449.79'	L681	S 02°57'16" E	375.00'	L769	S 34°42'11" W	172.43'
L594	N 07°56'35" W	347.55'	L682	S 89°58'23" E	449.25'	L770	N 89°04'12" W	535.44'
L595	N 07°07'31" E	401.12'	L683	S 00°00'01" E	940.51'	L771	N 06°12'15" W	601.39'
L596	N 12°45'45" E	203.04'	L684	S 89°59'58" W	232.11'	L772	N 24°35'52" W	437.88'
L597	N 02°51'02" E	592.61'	L685	S 26°43'58" E	302.42'	L773	N 89°26'04" E	668.88'
L598	S 89°45'50" E	284.42'	L686	S 63°59'42" W	9.62'	L774	S 00°47'14" E	76.68'
L599	S 41°22'20" E	409.67'	L687	S 27°07'07" E	25.02'	L775	N 89°04'16" E	614.97'
L600	N 88°47'20" W	480.05'	L688	S 52°16'46" E	246.17'	L776	N 22°01'45" W	197.88'
L601	S 01°49'21" E	464.44'	L689	N 42°35'44" E	202.61'	L777	N 05°50'01" E	596.01'
L602	S 89°29'29" E	62.00'	L690	S 86°12'00" E	258.96'	L778	N 82°04'24" E	269.13'
L603	S 00°29'43" W	128.00'	L691	N 00°04'42" W	287.13'	L779	N 00°19'19" W	355.37'
L604	S 88°34'48" E	126.92'	L692	N 87°44'00" E	319.16'	L780	S 89°04'16" W	177.16'
L605	S 00°20'12" W	194.30'	L693	S 00°04'42" E	867.77'	L781	N 33°20'58" W	227.33'
L606	S 89°48'28" E	312.11'	L694	N 52°26'39" W	172.17'	L782	N 23°23'27" W	74.46'
L607	S 14°41'55" E	199.32'	L695	N 62°08'23" W	53.86'	L783	N 31°43'44" E	341.56'
L608	N 88°05'55" E	301.98'	L696	S 42°58'04" W	22.52'	L784	N 70°12'22" W	61.39'
L609	N 00°37'18" E	22.57'	L697	N 46°31'33" W	158.05'	L785	N 84°08'44" W	70.08'



ANNEXATION STUDY AREA 1A (2017) EXHIBIT

A part of Sections 20, 29, 30 and 31, Township 9 North, Range 1 West, Sections 25, 26, 35 and 36, Township 9 North, Range 2 West, Sections 1, 2, 3, 11, 12 and 14, Township 8 North, Range 2 West, Monroe County, Indiana

AREA 1A LINE TABLE		
L786	N 89°46'18" W	438.78'
L787	S 88°18'21" W	145.23'
L788	S 74°47'04" W	72.67'
L789	S 67°06'19" W	39.95'
L790	S 56°46'31" W	44.23'
L791	S 47°55'12" W	43.41'
L792	S 45°00'27" W	130.47'
L793	S 44°59'33" E	55.00'
L794	S 38°46'08" E	100.65'
L795	S 30°11'55" E	65.44'
L796	S 21°57'14" E	49.22'
L797	S 71°19'12" W	88.21'
L798	N 54°05'21" W	346.21'
L799	N 23°48'58" E	250.25'
L800	N 89°45'37" W	287.30'
L801	N 77°25'57" W	62.34'
L802	S 00°38'18" E	1370.62'
L803	N 89°32'53" W	781.97'
L804	S 00°39'47" E	1754.81'
L805	S 83°47'42" W	23.40'
L806	S 00°00'01" E	319.38'
L807	S 54°03'15" W	908.06'
L808	S 89°29'53" E	471.77'
L809	S 00°37'48" E	1316.86'
L810	N 89°34'21" W	660.00'
L811	S 00°38'22" E	328.24'
L812	S 88°08'40" E	638.45'
L813	S 00°45'36" E	536.76'
L814	N 89°34'20" W	8.50'
L815	S 00°48'13" E	462.01'
L816	S 89°34'26" E	8.50'
L817	S 00°48'13" E	336.93'
L818	N 89°34'20" W	8.50'
L819	S 00°48'12" E	110.00'
L820	S 89°34'26" E	8.50'
L821	S 00°48'13" E	110.02'
L822	N 89°34'20" W	8.50'
L823	S 00°48'20" E	110.04'
L824	S 89°32'16" E	352.47'
L825	S 00°48'13" E	373.36'
L826	S 89°07'16" E	366.62'
L827	S 01°03'21" E	116.06'
L828	N 89°12'18" W	14.64'
L829	S 01°15'58" E	63.86'
L830	S 44°35'38" W	47.13'
L831	N 89°52'38" W	152.52'
L832	N 01°40'40" W	32.82'
L833	N 86°56'53" W	166.67'
L834	S 00°48'12" E	68.67'
L835	N 89°50'37" W	1410.33'
L836	S 01°05'33" W	80.72'
L837	S 01°05'36" W	71.06'
L838	S 08°48'07" W	101.74'
L839	S 16°42'13" W	74.13'
L840	S 23°34'50" W	88.32'
L841	S 19°46'19" W	103.66'
L842	S 13°25'56" W	92.78'
L843	S 06°26'36" W	97.02'
L844	S 03°10'53" E	13.96'
L845	N 82°52'36" W	20.60'
L846	N 71°34'10" W	28.82'
L847	N 62°51'24" W	44.64'
L848	N 63°30'30" W	90.89'
L849	N 74°52'47" W	46.05'
L850	N 83°39'42" W	35.17'
L851	N 00°46'14" E	615.10'
L852	N 89°23'49" W	326.15'
L853	S 00°00'00" E	349.04'
L854	N 88°20'22" W	264.00'
L855	S 00°02'44" W	900.14'
L856	S 89°44'34" W	256.25'
L857	S 00°02'46" W	100.20'
L858	N 89°48'31" E	20.93'
L859	S 01°04'24" W	99.85'
L860	S 83°04'45" E	28.80'
L861	S 00°01'02" E	14.98'
L862	N 89°34'55" W	264.64'
L863	S 01°13'57" E	125.74'
L864	N 87°34'47" W	304.49'
L865	S 00°41'01" E	200.00'
L866	S 87°34'47" E	306.44'
L867	S 01°12'52" E	100.05'
L868	N 87°34'47" W	307.37'
L869	S 00°41'01" E	100.00'
L870	S 87°34'47" E	308.33'
L871	S 01°13'56" E	400.17'
L872	N 88°52'06" E	11.06'
L873	S 01°28'24" E	2600.65'

AREA 1A LINE TABLE		
L874	S 89°54'48" E	3964.53'
L875	S 00°18'01" E	917.06'
L876	S 54°17'04" W	754.63'
L877	S 54°13'03" W	2143.53'
L878	N 89°53'21" E	940.00'
L879	N 89°53'20" E	1417.21'
L880	S 00°04'32" W	2673.86'
L881	S 88°27'16" E	275.28'
L882	S 66°39'00" E	169.71'
L883	S 01°39'37" W	119.05'
L884	S 89°33'10" E	120.14'
L885	N 49°42'08" E	123.25'
L886	N 56°05'05" E	172.53'
L887	N 47°07'15" E	74.60'
L888	N 89°51'48" W	45.78'
L889	N 47°41'00" E	55.04'
L890	N 53°11'00" E	154.51'
L891	N 48°18'00" E	123.50'
L892	S 02°39'04" E	19.74'
L893	N 48°45'07" E	371.42'
L894	N 49°09'06" W	7.46'
L895	N 51°31'43" E	414.61'
L896	N 55°29'37" E	426.56'
L897	N 58°39'21" E	236.90'
L898	N 62°36'39" E	289.68'
L899	N 66°05'05" E	146.64'
L900	N 69°10'54" E	613.57'
L901	N 88°42'59" E	83.90'
L902	N 68°53'36" E	262.63'
L903	N 63°32'44" E	237.13'
L904	S 00°27'45" E	141.47'
L905	N 89°31'00" E	190.11'
L906	N 00°01'39" E	274.32'
L907	N 07°40'37" W	185.16'
L908	N 00°02'48" E	100.00'
L909	N 11°21'25" E	101.98'
L910	N 00°28'15" W	441.82'
L911	N 89°57'11" W	15.87'
L912	N 00°03'09" W	1711.37'
L913	N 89°32'23" E	293.09'
L914	S 00°00'00" E	196.20'
L915	S 00°00'00" E	199.50'
L916	S 01°18'40" E	108.03'
L917	N 89°59'57" W	252.61'
L918	S 00°28'02" E	60.61'
L919	N 90°00'00" E	252.05'
L920	S 00°17'17" E	198.91'
L921	S 89°31'01" W	245.57'
L922	S 00°11'14" E	1239.23'
L923	S 01°55'47" E	299.60'
L924	S 81°03'42" E	54.50'
L925	N 62°31'07" E	112.81'
L926	N 46°04'36" E	579.96'
L927	N 43°43'43" E	69.97'
L928	N 53°22'49" E	202.71'
L929	N 59°51'36" E	78.81'
L930	N 39°49'00" E	86.46'
L931	S 00°44'11" E	101.01'
L932	S 89°37'28" W	1287.77'
L933	N 00°41'20" W	101.00'
L934	N 89°37'28" E	1287.69'
L935	N 89°34'43" W	1330.63'
L936	N 27°09'47" E	3.25'
L937	N 57°57'12" E	199.99'
L938	N 62°39'26" E	381.91'
L939	N 00°03'01" W	22.47'
L940	S 89°20'01" E	34.59'
L941	N 56°17'34" E	417.02'
L942	N 59°20'41" E	120.96'
L943	N 69°42'27" E	83.53'
L944	N 83°47'22" E	70.80'
L945	S 90°00'00" E	56.73'
L946	S 00°22'47" E	787.40'

AREA 1A CURVE TABLE				
CURVE	ARC LENGTH	RADIUS	CHORD BEARING	CHORD LENGTH
C13	211.04'	1785.05'	N 03°12'54" E	210.92'
G14	430.24'	642.68'	S 83°13'30" E	130.02'
G15	163.34'	805.97'	S 84°43'33" E	163.06'
C16	98.45'	235.00'	N 18°03'52" W	97.73'
C17	526.47'	334.63'	N 44°23'29" E	473.83'
C18	88.78'	165.09'	N 74°35'08" E	87.71'
C19	1037.37'	2402.91'	N 30°08'22" E	1029.33'
C20	1134.63'	1510.18'	S 19°50'54" E	1108.14'
C21	262.28'	462.71'	N 01°52'42" E	258.78'
C22	180.94'	408.90'	S 39°47'43" E	179.47'
C23	65.35'	51.65'	N 04°35'22" W	61.07'
C24	7.91'	10.94'	N 24°48'42" W	7.74'
C28	190.07'	385.39'	N 41°17'00" E	188.15'

ANNEXATION STUDY AREA 1A (2017) EXHIBIT

A part of Sections 20, 29, 30 and 31, Township 9 North, Range 1 West, Sections 25, 26, 35 and 36, Township 9 North, Range 2 West, Sections 1, 2, 3, 11, 12 and 14, Township 8 North, Range 2 West, Monroe County, Indiana

AREA 1A LINE TABLE		
LINE	BEARING	DISTANCE
L1115	S 06°12'14" E	250.00'
L1116	S 83°47'50" W	325.53'
L1117	N 13°28'00" E	97.78'
L1118	N 55°26'46" E	80.95'
L1119	N 41°51'12" E	61.08'
L1120	N 04°04'56" E	79.94'
L1121	N 83°47'46" E	161.67'
L1122	S 89°04'59" E	1784.02'
L1123	S 00°23'12" E	2011.71'
L1124	S 89°22'12" W	764.96'
L1125	N 00°37'47" W	613.54'
L1126	S 00°37'48" E	46.97'
L1127	N 89°40'35" W	950.00'
L1128	N 00°37'48" W	80.62'
L1129	S 88°26'04" E	614.29'
L1130	N 01°33'44" E	925.00'
L1131	S 88°26'46" E	360.00'
L1132	N 01°33'44" E	360.00'
L1133	S 88°26'46" E	168.00'
L1134	N 01°33'44" E	419.68'
L1135	N 88°26'53" W	701.34'
L1136	N 89°35'04" W	11.00'
L1137	S 00°24'56" W	1257.00'
L1138	S 89°28'04" W	392.75'
L1139	S 89°32'05" W	367.50'
L1140	N 00°16'10" W	226.25'
L1141	N 89°32'05" E	367.50'
L1142	N 00°16'10" W	208.16'
L1143	N 89°26'08" E	392.63'
L1144	S 00°12'58" E	16.37'
L1145	N 89°21'52" E	101.22'
L1146	N 00°32'21" W	481.25'
L1147	N 89°13'05" E	155.00'
L1148	S 00°32'21" E	481.65'
L1149	N 89°37'46" E	206.64'
L1150	S 00°12'53" E	478.15'
L1151	S 89°55'21" W	76.51'
L1152	N 00°03'01" W	29.92'
L1153	S 89°42'26" W	2137.74'
L1154	S 89°59'55" W	14.61'
L1155	S 00°34'48" E	1314.60'
L1156	S 89°34'07" E	2601.41'
L1157	N 00°26'33" W	1742.95'

L1199	S 14°06'09" W	82.40'
L1200	S 00°26'33" E	1742.95'
L1201	N 89°34'07" W	2601.41'
L1202	N 00°31'18" W	1314.60'
L1203	N 89°59'55" E	14.61'
L1204	N 89°42'26" E	904.08'
L1205	N 00°17'34" W	66.20'
L1206	N 27°09'17" E	3.25'

AREA 1A CURVE TABLE				
CURVE	ARC LENGTH	RADIUS	CHORD BEARING	CHORD LENGTH
C29	46.36'	50.00'	N 25°56'07" E	44.72'
C30	203.45'	50.00'	N 64°03'53" W	89.44'
C31	691.69'	446.00'	S 47°01'22" W	624.13'
C32	626.72'	405.35'	N 40°56'30" E	566.14'

NOTE:

1. THIS PLAT AND ALL LINES SHOWN HEREON WERE PREPARED FROM RECORD INFORMATION OBTAINED FROM THE MONROE COUNTY INDIANA GEOGRAPHIC INFORMATION SYSTEM IN JANUARY, 2017 WITH REVISIONS IN MAY AND SEPTEMBER, 2021. NO FIELD WORK WAS PERFORMED. ALL BEARINGS AND DISTANCES ARE APPROXIMATE AND NO GUARANTY IS MADE AS TO THEIR ACCURACY.

2. THIS DRAWING IS NOT INTENDED TO BE REPRESENTED AS A RETRACEMENT OR ORIGINAL BOUNDARY SURVEY, A ROUTE SURVEY, OR A SURVEYOR LOCATION REPORT.

3. 3162.54 ACRES CALCULATED IN AREA 1A.

4. TOTAL LENGTH OF AREA 1A BOUNDARY: 173,436'
 CONTIGUOUS WITH EXISTING BOUNDARY: 71,712'
 NON-CONTIGUOUS WITH EXISTING BOUNDARY: 101,724'
 PERCENTAGE OF AREA 1A CONTIGUOUS WITH EXISTING CITY OF BLOOMINGTON BOUNDARY: 41.3%.

5. LINES 528, 529, 809, 935-936, 1129-1137 AND 1151-1157 AND CURVES 14, 15 AND 31 INTENTIONALLY DELETED IN SEPTEMBER, 2021.

Bledsoe Riggert Cooper James

LAND SURVEYING • CIVIL ENGINEERING • GIS

City of Bloomington Indiana Annexation Study Area Number 1A Legal Description:

The intent of the following description is to describe the City of Bloomington Annexation Study Area Number 1A as provided by the City of Bloomington Indiana Geographic Information System Department in January, 2017 with revisions in May and September, 2021. The following described lines are intended to be coincident with existing annexation ordinance and parcel boundary lines. No field work was performed in preparing this description. Bearings and distances shown were taken from the Monroe County Geographic Information System files.

A part of Sections 20, 29, 30 and 31, Township 9 North, Range 1 West, Sections 25, 26, 35 and 36, Township 9 North, Range 2 West, Sections 1, 2, 3, 11, 12 and 14, Township 8 North, Range 2 West Monroe County, Indiana, more particularly described as:

Beginning at a southern corner of Ordinance 95-53 on the northern right of way line of State Road 45; thence coincident with said Ordinance 95-53 the following 3 courses:

- 1) NORTH 34 degrees 04 minutes 14 seconds WEST a distance of 354.36 feet;
- 2) NORTH 00 degrees 35 minutes 45 seconds EAST a distance of 806.57 feet;
- 3) NORTH 88 degrees 14 minutes 55 seconds EAST a distance of 777.49 feet to a corner of Ordinance 98-46;

thence coincident with said Ordinance 98-46 the following 4 courses:

- 1) NORTH 00 degrees 10 minutes 19 seconds WEST a distance of 261.27 feet to the point of curvature of a curve concave easterly, with a radius of 1785.05 feet, a chord bearing of NORTH 03 degrees 12 minutes 54 seconds EAST, with a chord length of 210.92 feet;
- 2) along said curve a distance of 211.04 feet;
- 3) SOUTH 89 degrees 28 minutes 58 seconds WEST a distance of 745.08 feet;
- 4) NORTH 00 degrees 29 minutes 53 seconds EAST a distance of 1037.10 feet to the south line of Lot 4A of Park 37 Phase III Final Plat Amendment One, as recorded in Instrument Number 2018006889;

thence coincident with said south line SOUTH 89 degrees 28 minutes 04 seconds WEST a distance of 392.75 feet to the southeast corner of Lot 19 of Park 37 Phase IX, as recorded in Plat Cabinet C, Envelope 164; thence coincident with the lines of said Lot 19 the following 3 courses:

- 1) SOUTH 89 degrees 32 minutes 05 seconds WEST a distance of 367.50 feet;
- 2) NORTH 00 degrees 16 minutes 10 seconds WEST a distance of 226.25 feet;
- 3) NORTH 89 degrees 32 minutes 05 seconds EAST a distance of 367.50 feet to the west line of said Lot 4A;

thence coincident with the lines of said Lot 4A the following 9 courses:

- 1) NORTH 00 degrees 16 minutes 10 seconds WEST a distance of 208.16 feet;
- 2) NORTH 89 degrees 26 minutes 08 seconds EAST a distance of 392.63 feet;
- 3) SOUTH 00 degrees 12 minutes 58 seconds EAST a distance of 16.37 feet;
- 4) NORTH 89 degrees 21 minutes 52 seconds EAST a distance of 101.22 feet;
- 5) NORTH 00 degrees 32 minutes 21 seconds WEST a distance of 481.25 feet;
- 6) NORTH 89 degrees 13 minutes 05 seconds EAST a distance of 155.00 feet;
- 7) SOUTH 00 degrees 32 minutes 21 seconds EAST a distance of 481.65 feet;
- 8) NORTH 89 degrees 37 minutes 46 seconds EAST a distance of 206.64 feet;
- 9) SOUTH 00 degrees 12 minutes 53 seconds EAST a distance of 478.15 feet to a north line of said Ordinance 98-46;

thence coincident with said north line NORTH 89 degrees 28 minutes 06 seconds EAST a distance of 1265.82 feet to the west line of Ordinance 94-57; thence coincident with the west line of said Ordinance 94-57 NORTH 00 degrees 01 minutes 15 seconds EAST a distance of 1194.02 feet to the southwest corner of Ordinance 02-23; thence coincident with said Ordinance 02-23 the following 6 courses:

- 1) NORTH 04 degrees 32 minutes 45 seconds WEST a distance of 99.91 feet;
- 2) NORTH 00 degrees 36 minutes 29 seconds WEST a distance of 250.22 feet;
- 3) NORTH 01 degrees 44 minutes 18 seconds WEST a distance of 1249.31 feet;
- 4) NORTH 11 degrees 49 minutes 32 seconds WEST a distance of 102.27 feet;
- 5) NORTH 07 degrees 24 minutes 46 seconds EAST a distance of 151.87 feet;
- 6) NORTH 06 degrees 06 minutes 54 seconds EAST a distance of 405.76 feet to the southwest corner of Ordinance 97-48 on the north right of way line of the Indiana Railroad;

thence coincident with the west line of said Ordinance 97-48 NORTH 01 degrees 05 minutes 04 seconds EAST a distance of 378.82 feet to the southeast corner of Ordinance 94-63; thence coincident with said Ordinance 94-63 NORTH 89 degrees 28 minutes 49 seconds WEST a distance of 1449.25 feet to the southeast corner of Ordinance 96-52; thence coincident with said Ordinance 96-52 the following 5 courses:

- 1) NORTH 90 degrees 00 minutes 00 seconds WEST a distance of 102.90 feet;
- 2) NORTH 00 degrees 00 minutes 00 seconds WEST a distance of 42.00 feet;
- 3) NORTH 90 degrees 00 minutes 00 seconds WEST a distance of 668.00 feet;
- 4) NORTH 00 degrees 00 minutes 00 seconds WEST a distance of 619.00 feet;
- 5) SOUTH 88 degrees 23 minutes 44 seconds WEST a distance of 1303.67 feet to an eastern line of Ordinance 67-13;

thence coincident with said eastern line of said Ordinance 67-13 SOUTH 00 degrees 02 minutes 00 seconds EAST a distance of 130.00 feet; thence coincident with a south line of said Ordinance 67-13 and said line extended SOUTH 89 degrees 11 minutes 00 seconds WEST a distance of 417.00 feet to an eastern line of Ordinance 67-13 thence coincident with said eastern line SOUTH 00 degrees 09 minutes 08 seconds WEST a distance of 1800.28 feet to the north line of Ordinance 73-54; thence coincident with said Ordinance 73-54 the following 4 courses:

- 1) SOUTH 89 degrees 00 minutes 00 seconds EAST a distance of 82.45 feet;
- 2) SOUTH 01 degrees 17 minutes 24 seconds WEST a distance of 1446.48 feet;
- 3) SOUTH 88 degrees 10 minutes 56 seconds WEST a distance of 1235.99 feet;
- 4) NORTH 01 degrees 01 minutes 03 seconds WEST a distance of 1504.25 feet to the southwest corner of Ordinance 70-11;

thence coincident with said Ordinance 70-11 the following 2 courses:

- 1) NORTH 01 degrees 25 minutes 16 seconds WEST a distance of 1779.71 feet;
- 2) NORTH 89 degrees 38 minutes 00 seconds EAST a distance of 810.25 feet to a northwest corner of Ordinance 67-22;

thence coincident with the north line of Ordinance 67-22 NORTH 89 degrees 24 minutes 29 seconds EAST a distance of 154.84 feet to the west line of Ordinance 67-03; thence coincident with said west line NORTH 00 degrees 02 minutes 35 seconds WEST a distance of 500.23 feet to the northwest corner of said Ordinance 67-03 on the north right of way line of State Highway 48; thence coincident with the north line of said Ordinance 67-03 on said north right of way line NORTH 89 degrees 59 minutes 48 seconds EAST a distance of 1596.10 feet to the west line of Ordinance 72-27; thence coincident with said west line NORTH 01

Bledsoe Riggert Cooper James

LAND SURVEYING • CIVIL ENGINEERING • GIS

degrees 34 minutes 00 seconds WEST a distance of 211.27 feet to a southwest corner of Ordinance 96-51; thence coincident with said Ordinance 96-51 the following 6 courses:

- 1) NORTH 00 degrees 00 minutes 00 seconds WEST a distance of 623.27 feet;
- 2) NORTH 90 degrees 00 minutes 00 seconds EAST a distance of 733.00 feet;
- 3) SOUTH 00 degrees 00 minutes 00 seconds EAST a distance of 76.75 feet;
- 4) NORTH 90 degrees 00 minutes 00 seconds EAST a distance of 90.00 feet;
- 5) SOUTH 00 degrees 00 minutes 00 seconds EAST a distance of 64.00 feet;
- 6) NORTH 90 degrees 00 minutes 00 seconds EAST a distance of 340.00 feet to the west line of Ordinance 67-13;

thence coincident with said Ordinance 67-13 the following 4 courses:

- 1) NORTH 01 degrees 19 minutes 09 seconds EAST a distance of 383.01 feet;
- 2) NORTH 90 degrees 00 minutes 00 seconds EAST a distance of 394.87 feet;
- 3) SOUTH 00 degrees 00 minutes 00 seconds EAST a distance of 55.72 feet;
- 4) NORTH 90 degrees 00 minutes 00 seconds EAST a distance of 358.84 feet to the southwest corner of Ordinance 97-41 on the west line of Gates Drive;

thence coincident with said Ordinance 97-41 the following 12 courses:

- 1) NORTH 17 degrees 55 minutes 33 seconds WEST a distance of 73.05 feet;
- 2) NORTH 25 degrees 05 minutes 36 seconds WEST a distance of 28.61 feet;
- 3) NORTH 30 degrees 03 minutes 59 seconds WEST a distance of 142.25 feet to the point of curvature of a curve concave to the northeast with a radius of 235.00 feet, a chord bearing of NORTH 18 degrees 03 minutes 52 seconds WEST with a chord length of 97.73 feet;
- 4) Along said curve a distance of 98.45 feet;
- 5) NORTH 00 degrees 40 minutes 46 seconds WEST a distance of 962.35 feet to the point of curvature of a curve concave to the southeast with a radius of 334.63 feet, a chord bearing of NORTH 44 degrees 23 minutes 29 seconds EAST and a chord length of 473.83 feet;
- 6) Along said curve a distance of 526.47 feet;
- 7) NORTH 89 degrees 59 minutes 28 seconds EAST a distance of 121.88 feet to the point of curvature of a curve concave northerly, with a radius of 165.09 feet, a chord bearing of NORTH 74 degrees 35 minutes 08 seconds EAST and a chord length of 87.81 feet;
- 8) along said curve a distance of 88.78 feet;
- 9) NORTH 59 degrees 10 minutes 11 seconds EAST a distance of 63.98 feet;
- 10) NORTH 89 degrees 26 minutes 53 seconds EAST a distance of 240.86 feet;
- 11) NORTH 00 degrees 33 minutes 07 seconds WEST a distance of 500.00 feet;
- 12) SOUTH 83 degrees 04 minutes 10 seconds EAST a distance of 1493.24 feet to a corner of Ordinance 02-22;

thence coincident with said Ordinance 02-22 the following 38 courses:

- 1) NORTH 47 degrees 00 minutes 27 seconds EAST a distance of 355.25 feet;
- 2) NORTH 35 degrees 41 minutes 54 seconds EAST a distance of 101.98 feet;
- 3) NORTH 47 degrees 00 minutes 30 seconds EAST a distance of 600.00 feet;
- 4) NORTH 55 degrees 32 minutes 21 seconds EAST a distance of 404.48 feet;
- 5) NORTH 47 degrees 00 minutes 30 seconds EAST a distance of 600.00 feet;
- 6) NORTH 63 degrees 42 minutes 27 seconds EAST a distance of 104.40 feet;
- 7) NORTH 47 degrees 00 minutes 30 seconds EAST a distance of 500.00 feet;
- 8) NORTH 42 degrees 43 minutes 09 seconds EAST a distance of 200.56 feet;
- 9) NORTH 46 degrees 35 minutes 12 seconds EAST a distance of 508.64 feet;
- 10) NORTH 42 degrees 30 minutes 26 seconds EAST a distance of 142.94 feet to the point of curvature of a curve concave to the northwest, with a radius of 2402.91 feet, a chord bearing of NORTH 30 degrees 08 minutes 22 seconds EAST, and a chord length of 1029.33 feet;
- 11) along said curve a distance of 1037.37 feet;
- 12) NORTH 07 degrees 50 minutes 47 seconds EAST a distance of 180.80 feet;
- 13) NORTH 15 degrees 30 minutes 30 seconds EAST a distance of 759.25 feet;
- 14) NORTH 01 degrees 28 minutes 20 seconds EAST a distance of 103.08 feet;
- 15) NORTH 14 degrees 27 minutes 41 seconds EAST a distance of 558.98 feet;
- 16) NORTH 10 degrees 08 minutes 30 seconds EAST a distance of 615.10 feet;
- 17) NORTH 19 degrees 58 minutes 48 seconds EAST a distance of 200.72 feet;
- 18) NORTH 04 degrees 33 minutes 21 seconds EAST a distance of 449.79 feet;
- 19) NORTH 07 degrees 56 minutes 35 seconds WEST a distance of 347.55 feet;
- 20) NORTH 07 degrees 07 minutes 31 seconds EAST a distance of 401.12 feet;
- 21) NORTH 12 degrees 45 minutes 45 seconds EAST a distance of 203.04 feet;
- 22) NORTH 02 degrees 51 minutes 02 seconds EAST a distance of 592.61 feet;
- 23) SOUTH 89 degrees 45 minutes 50 seconds EAST a distance of 284.42 feet;
- 24) SOUTH 41 degrees 22 minutes 20 seconds EAST a distance of 409.67 feet to the point of curvature of a curve concave to the southwest, with a radius of 1510.18 feet, a chord bearing of SOUTH 19 degrees 50 minutes 54 seconds EAST, with a chord length of 1108.14 feet;
- 25) Along said curve a distance of 1134.63 feet;
- 26) NORTH 88 degrees 47 minutes 20 seconds WEST a distance of 480.05 feet;
- 27) SOUTH 01 degrees 49 minutes 21 seconds EAST a distance of 464.44 feet;
- 28) SOUTH 89 degrees 29 minutes 29 seconds EAST a distance of 62.00 feet;
- 29) SOUTH 00 degrees 29 minutes 43 seconds WEST a distance of 128.00 feet;
- 30) SOUTH 88 degrees 34 minutes 48 seconds EAST a distance of 126.92 feet;
- 31) SOUTH 00 degrees 20 minutes 12 seconds WEST a distance of 194.30 feet;
- 32) SOUTH 89 degrees 48 minutes 28 seconds EAST a distance of 312.11 feet;
- 33) SOUTH 14 degrees 41 minutes 55 seconds EAST a distance of 199.32 feet;
- 34) NORTH 88 degrees 05 minutes 55 seconds EAST a distance of 301.98 feet;
- 35) NORTH 00 degrees 37 minutes 18 seconds EAST a distance of 22.57 feet;
- 36) SOUTH 87 degrees 50 minutes 00 seconds EAST a distance of 57.85 feet;
- 37) NORTH 75 degrees 28 minutes 03 seconds EAST a distance of 104.40 feet;
- 38) SOUTH 87 degrees 50 minutes 00 seconds EAST a distance of 532.90 feet to the southwest corner of Ordinance 97-43;

thence coincident with said Ordinance 97-43 the following 4 courses:

Bledsoe Riggert Cooper James

LAND SURVEYING • CIVIL ENGINEERING • GIS

- 1) NORTH 01 degrees 46 minutes 04 seconds EAST a distance of 189.49 feet;
- 2) SOUTH 88 degrees 30 minutes 19 seconds EAST a distance of 300.00 feet;
- 3) NORTH 00 degrees 00 minutes 00 seconds WEST a distance of 80.93 feet;
- 4) NORTH 89 degrees 59 minutes 56 seconds EAST a distance of 165.85 feet to the northwest corner of Ordinance 96-53;

thence coincident with said Ordinance 96-53 NORTH 89 degrees 59 minutes 56 seconds EAST a distance of 165.84 feet; thence continuing coincident with said Ordinance 96-53 SOUTH 00 degrees 23 minutes 46 seconds EAST a distance of 90.37 feet to a northwestern corner of Ordinance 95-65; thence coincident with said Ordinance 95-65 the following 4 courses:

- 1) SOUTH 88 degrees 30 minutes 19 seconds EAST a distance of 231.98 feet;
- 2) NORTH 00 degrees 00 minutes 00 seconds WEST a distance of 455.22 feet;
- 3) NORTH 90 degrees 00 minutes 00 seconds EAST a distance of 252.20 feet;
- 4) SOUTH 01 degrees 45 minutes 33 seconds EAST a distance of 82.77 feet to a northwestern corner of Ordinance 74-45;

thence coincident with said Ordinance 74-45 the following 6 courses:

- 1) NORTH 89 degrees 58 minutes 42 seconds EAST a distance of 492.32 feet;
- 2) NORTH 00 degrees 00 minutes 00 seconds WEST a distance of 780.20 feet;
- 3) NORTH 90 degrees 00 minutes 00 seconds WEST a distance of 8.25 feet;
- 4) NORTH 00 degrees 00 minutes 00 seconds WEST a distance of 572.00 feet;
- 5) NORTH 90 degrees 00 minutes 00 seconds EAST a distance of 419.00 feet;
- 6) NORTH 00 degrees 00 minutes 00 seconds WEST a distance of 431.13 feet to the south line of Ordinance 59-19;

thence coincident with said south line SOUTH 89 degrees 53 minutes 05 seconds WEST a distance of 452.31 feet to the southeast corner of Ordinance 60-12; thence coincident with the south line of said Ordinance 60-12 NORTH 89 degrees 26 minutes 28 seconds WEST a distance of 300.00 feet to the southeast corner of Ordinance 61-26; thence coincident with said Ordinance 61-26 the following 2 courses:

- 1) NORTH 89 degrees 19 minutes 06 seconds WEST a distance of 1106.13 feet;
- 2) NORTH 00 degrees 35 minutes 36 seconds WEST a distance of 943.94 feet to a southeast corner of Ordinance 73-14;

thence coincident with said Ordinance 73-14 the following 3 courses:

- 1) NORTH 89 degrees 10 minutes 26 seconds WEST a distance of 804.71 feet;
- 2) SOUTH 00 degrees 35 minutes 36 seconds EAST a distance of 132.00 feet;
- 3) NORTH 89 degrees 10 minutes 36 seconds WEST a distance of 493.66 feet to the southwest corner of said Ordinance 73-14, said corner being 25 feet east of the centerline of Prow Road per said Ordinance;

thence leaving said Ordinance 73-14 and the existing City of Bloomington boundary SOUTH 16 degrees 14 minutes 17 seconds WEST a distance of 97.86 feet to the intersection of said centerline and the southern right of way line of a railroad; thence coincident with said right of way line the following 5 courses:

- 1) NORTH 51 degrees 26 minutes 13 seconds WEST a distance of 72.76 feet;
- 2) NORTH 58 degrees 51 minutes 30 seconds WEST a distance of 134.84 feet;
- 3) NORTH 62 degrees 22 minutes 40 seconds WEST a distance of 398.78 feet;
- 4) NORTH 13 degrees 39 minutes 36 seconds EAST a distance of 22.71 feet;
- 5) NORTH 62 degrees 19 minutes 32 seconds WEST a distance of 335.37 feet to the west right of way line of State Road 37;

thence coincident with said right of way line the following 3 courses:

- 1) SOUTH 02 degrees 50 minutes 09 seconds WEST a distance of 758.29 feet;
- 2) SOUTH 49 degrees 16 minutes 10 seconds WEST a distance of 43.81 feet;
- 3) NORTH 53 degrees 05 minutes 40 seconds WEST a distance of 355.53 feet to the intersection of said west right of way line and the northeast right of way line of Arlington Road;

thence leaving said west right of way line of State Road 37 and said northeast right of way line of Arlington Road NORTH 78 degrees 50 minutes 44 seconds WEST a distance of 100.87 feet to the southwest right of way line of said Arlington Road; thence coincident with said southwest right of way line SOUTH 32 degrees 53 minutes 05 seconds EAST a distance of 172.00 feet; thence continuing coincident with said southwest right of way line SOUTH 41 degrees 12 minutes 19 seconds EAST a distance of 27.05 feet to the northeast corner of a parcel in the name of Chadd A. Brummett, as recorded in Instrument Number 2013019769; thence coincident with the north line of said parcel SOUTH 89 degrees 59 minutes 58 seconds WEST a distance of 233.25 feet to the west line of the Southwest Quarter of Section 20, Township 9 North, Range 1 West; thence coincident with said west line SOUTH 00 degrees 14 minutes 43 seconds EAST a distance of 524.48 feet to the northeast corner of the Northeast Quarter of Section 30, Township 9 North, Range 1 West; thence coincident with the east line of said quarter SOUTH 01 degrees 26 minutes 13 seconds EAST a distance of 782.31 feet to the intersection of said east line with the north line of a parcel in the name of Ledge Wall Quarry, LLC, as recorded in Instrument Number 2017000138; thence coincident with the lines of said parcel the following 2 courses:

- 1) SOUTH 89 degrees 41 minutes 55 seconds WEST a distance of 1641.28 feet;
- 2) SOUTH 50 degrees 53 minutes 44 seconds WEST a distance of 30.35 feet to an eastern line of Tract A-6 in North Park as recorded in Plat Cabinet D, Envelope 109;

thence coincident with the lines of Tract A-6 the following 2 courses:

- 1) SOUTH 15 degrees 14 minutes 21 seconds EAST a distance of 187.79 feet;
- 2) SOUTH 59 degrees 13 minutes 56 seconds WEST a distance of 951.39 feet to the eastern right of way line of Stone Branch Drive as shown on said plat of North Park;

thence coincident with said eastern right of way line the following 4 courses:

- 1) NORTH 14 degrees 21 minutes 36 seconds WEST a distance of 31.80 feet to the point of curvature of a curve concave to the east, with a radius of 462.71 feet, a chord bearing of NORTH 01 degrees 52 minutes 42 seconds EAST, and a chord length of 258.78 feet;
- 2) Northerly along said curve a distance of 262.28 feet;
- 3) NORTH 18 degrees 27 minutes 04 seconds EAST a distance of 158.30 feet;
- 4) NORTH 00 degrees 25 minutes 00 seconds EAST a distance of 781.92 feet;

thence coincident with said eastern right of way line and said line extended NORTH 04 degrees 30 minutes 22 seconds EAST a distance of 241.16 feet to the north line of said Section 30; thence coincident with said north line SOUTH 89 degrees 36 minutes 46 seconds WEST a distance of 1980.28 feet to the intersection of said north line and the northern right of way line of Curry Pike; thence coincident with said northern right of way line the following 9 courses:

- 1) SOUTH 46 degrees 00 minutes 12 seconds WEST a distance of 78.78 feet;
- 2) SOUTH 65 degrees 03 minutes 54 seconds WEST a distance of 469.14 feet;
- 3) SOUTH 77 degrees 51 minutes 26 seconds WEST a distance of 155.41 feet;

Bledsoe Riggert Cooper James

LAND SURVEYING • CIVIL ENGINEERING • GIS

- 4) SOUTH 71 degrees 43 minutes 01 seconds WEST a distance of 165.56 feet;
- 5) SOUTH 80 degrees 03 minutes 03 seconds WEST a distance of 170.24 feet;
- 6) SOUTH 78 degrees 15 minutes 22 seconds WEST a distance of 166.07 feet;
- 7) SOUTH 74 degrees 34 minutes 23 seconds WEST a distance of 135.89 feet;
- 8) SOUTH 73 degrees 31 minutes 13 seconds WEST a distance of 97.23 feet
- 9) NORTH 00 degrees 09 minutes 10 seconds WEST a distance of 1.80 feet to the southeast corner of a parcel in the name of the Monroe County Commissioners, as recorded in Instrument Number 2003006190;

thence coincident with the north line of said parcel the following 2 courses:

- 1) SOUTH 80 degrees 12 minutes 12 seconds WEST a distance of 163.94 feet;
- 2) SOUTH 64 degrees 39 minutes 24 seconds WEST a distance of 104.13 feet to the intersection of said north line and the extended west line of a parcel in the name of Indiana University Health Bloomington, as recorded in Instrument Number 20140000130;

thence leaving said north line and coincident with said extended west line SOUTH 00 degrees 33 minutes 59 seconds EAST a distance of 207.27 feet to the southern right of way line of said Curry Pike; thence continuing coincident with said extended west line SOUTH 00 degrees 33 minutes 59 seconds EAST a distance of 1020.76 feet to the southern right of way line of Woodyard Road; thence coincident with said southern right of way the following 6 courses:

- 1) SOUTH 72 degrees 39 minutes 11 seconds EAST a distance of 204.92 feet;
- 2) NORTH 03 degrees 41 minutes 18 seconds EAST a distance of 9.76 feet;
- 3) SOUTH 73 degrees 19 minutes 02 seconds EAST a distance of 875.19 feet;
- 4) SOUTH 72 degrees 12 minutes 55 seconds EAST a distance of 134.90 feet;
- 5) SOUTH 01 degrees 49 minutes 23 seconds EAST a distance of 11.57 feet;
- 6) SOUTH 65 degrees 10 minutes 17 seconds EAST a distance of 15.00 feet to the intersection of said southern right of way and the extension of an eastern line of Tract B-5 of said North Park;

thence coincident with the lines of said North Park the following 4 courses:

- 1) NORTH 00 degrees 13 minutes 52 seconds WEST a distance of 274.25 feet;
- 2) SOUTH 62 degrees 29 minutes 16 seconds EAST a distance of 871.52 feet;
- 3) SOUTH 02 degrees 57 minutes 16 seconds EAST a distance of 375.00 feet;
- 4) SOUTH 89 degrees 58 minutes 23 seconds EAST a distance of 449.25 feet to the northwest corner of a parcel in the name of H2R, LLC, as recorded in Instrument Number 2006019524;

thence coincident with the west line of said parcel SOUTH 00 degrees 00 minutes 01 seconds EAST a distance of 940.51 feet to a corner of said parcel; thence coincident with a northern line and said northern line extended SOUTH 89 degrees 59 minutes 58 seconds WEST a distance of 232.11 feet to the western right of way line of Woodyard Road; thence coincident with said western right of way the following 5 courses:

- 1) SOUTH 26 degrees 43 minutes 58 seconds EAST a distance of 302.42 feet;
- 2) SOUTH 63 degrees 59 minutes 42 seconds WEST a distance of 9.62 feet;
- 3) SOUTH 27 degrees 07 minutes 07 seconds EAST a distance of 25.02 feet to the point of curvature of a curve concave to the northeast, with a radius of 408.90 feet, a chord bearing of SOUTH 39 degrees 47 minutes 43 seconds EAST and a chord length of 179.47 feet;
- 4) thence southerly along said curve a distance of 180.94 feet;
- 5) SOUTH 52 degrees 16 minutes 46 seconds EAST a distance of 246.17 feet to the intersection of said western right of way line and an extended southeastern line of said H2R, LLC parcel;

thence coincident with said extended line and the lines of said parcel the following 4 courses:

- 1) NORTH 42 degrees 35 minutes 44 seconds EAST a distance of 202.61 feet;
- 2) SOUTH 86 degrees 12 minutes 00 seconds EAST a distance of 258.96 feet;
- 3) NORTH 00 degrees 04 minutes 42 seconds WEST a distance of 287.13 feet;
- 4) NORTH 87 degrees 44 minutes 00 seconds EAST a distance of 319.16 feet to the east line of the Southwest Quarter of said Section 30;

thence coincident with said east line SOUTH 00 degrees 04 minutes 42 seconds EAST a distance of 867.77 feet to the north right of way line of the former alignment of West Woodyard Road; thence coincident with said north right of way line the following 7 courses:

- 1) NORTH 52 degrees 26 minutes 39 seconds WEST a distance of 172.17 feet;
- 2) NORTH 62 degrees 08 minutes 23 seconds WEST a distance of 53.86 feet;
- 3) SOUTH 42 degrees 58 minutes 04 seconds WEST a distance of 22.52 feet;
- 4) NORTH 46 degrees 31 minutes 33 seconds WEST a distance of 158.05 feet;
- 5) NORTH 47 degrees 37 minutes 45 seconds WEST a distance of 62.99 feet;
- 6) NORTH 50 degrees 38 minutes 22 seconds WEST a distance of 51.67 feet;
- 7) NORTH 54 degrees 51 minutes 22 seconds WEST a distance of 42.87 feet;

thence leaving said north right of way line SOUTH 58 degrees 03 minutes 24 seconds WEST a distance of 237.38 feet to the western right of way line of Woodyard Road; thence coincident with said western right of way line SOUTH 01 degrees 09 minutes 55 seconds EAST a distance of 853.05 feet to the north right of way line of Vernal Pike; thence coincident with said north line NORTH 89 degrees 05 minutes 20 seconds WEST a distance of 459.81 feet to the east line of a parcel in the name of Joseph D. Cox, as recorded in Instrument Number 200415930; thence coincident with the lines of said parcel the following 3 courses:

- 1) NORTH 00 degrees 28 minutes 04 seconds WEST a distance of 175.29 feet;
- 2) SOUTH 89 degrees 47 minutes 31 seconds WEST a distance of 150.00 feet;
- 3) SOUTH 00 degrees 18 minutes 13 seconds EAST a distance of 171.64 feet to said north right of way line of Vernal Pike;

thence coincident with said north right of way line SOUTH 89 degrees 25 minutes 20 seconds WEST a distance of 131.83 feet to the intersection of said north right of way line and the extended west line of a parcel in the name of Nancy E. Melvin as recorded in Instrument Number 2000000819; thence coincident with said west line extended and said west line SOUTH 00 degrees 02 minutes 11 seconds EAST a distance of 292.75 feet to a northern line of a parcel in the name of Tina M. Pierce, as recorded in Instrument Number 2013020870; thence coincident with the line of said parcel the following 7 courses:

- 1) SOUTH 86 degrees 41 minutes 15 seconds WEST a distance of 126.61 feet;
- 2) SOUTH 89 degrees 48 minutes 50 seconds WEST a distance of 232.97 feet;
- 3) SOUTH 00 degrees 00 minutes 01 seconds EAST a distance of 985.47 feet;
- 4) SOUTH 73 degrees 00 minutes 56 seconds WEST a distance of 90.59 feet;
- 5) SOUTH 67 degrees 19 minutes 36 seconds WEST a distance of 91.71 feet;
- 6) SOUTH 60 degrees 44 minutes 49 seconds WEST a distance of 16.62 feet;

Bledsoe Riggert Cooper James

LAND SURVEYING • CIVIL ENGINEERING • GIS

- 7) SOUTH 89 degrees 59 minutes 58 seconds WEST a distance of 239.68 feet to the west line of Section 31, Township 9 North, Range 1 West;

thence coincident with said west line SOUTH 00 degrees 28 minutes 16 seconds EAST a distance of 159.07 feet to the southeast corner of a parcel in the name of Daniel K. and Elizabeth A. Helton, as recorded in Deed Book 482, Page 528; thence coincident with the lines of said parcel the following 4 courses:

- 1) SOUTH 45 degrees 53 minutes 31 seconds WEST a distance of 200.52 feet to the point of curvature of a non-tangent curve concave to the west, with a radius of 51.65 feet, a chord bearing of NORTH 04 degrees 35 minutes 22 seconds WEST and a chord length of 61.07 feet;
- 2) Northerly along said curve a distance of 65.35 feet;
- 3) NORTH 45 degrees 31 minutes 45 seconds WEST a distance of 12.49 feet to the point of curvature of a curve concave to the northeast, with a radius of 10.94 feet, a chord bearing of NORTH 24 degrees 48 minutes 42 seconds WEST, and a chord length of 7.74 feet;
- 4) Northerly along said curve a distance of 7.91 feet to the east right of way line of Logan Road;

thence coincident with said east right of way line NORTH 00 degrees 37 minutes 35 seconds WEST a distance of 887.80 feet to the intersection of said east right of way line and the extended southern line of a parcel in the name of Phyllis J. Stewart, as recorded in Instrument Number 2014008898; thence coincident with said southern line extended and said southern line SOUTH 89 degrees 11 minutes 57 seconds WEST a distance of 211.49 feet to the southwest corner of said parcel; thence coincident with the west lines of said parcel and the following 3 parcels in the names of:

- 1) Tonya M. Wampler, as recorded in Instrument Number 2001003343
- 2) Paul F. and Edna Finch, as recorded in Deed Book 396, Page 591
- 3) Wanda L. Peterson, as recorded in Instrument Number 2012008953

NORTH 00 degrees 28 minutes 16 seconds WEST a distance of 611.45 feet to the northwest corner of said Peterson parcel; thence continuing NORTH 00 degrees 28 minutes 16 seconds WEST a distance of 96.25 feet to the northern right of way line of Vernal Pike; thence coincident with said northern right of way line the following 2 courses:

- 1) NORTH 78 degrees 19 minutes 48 seconds EAST a distance of 79.91 feet;
- 2) SOUTH 89 degrees 50 minutes 43 seconds EAST a distance of 28.17 feet to the eastern line of a parcel in the name of Acacia Investments LLC and Texin LLC, as recorded in Instrument Number 2007013897;

thence coincident with the lines of said parcel the following 5 courses:

- 1) NORTH 00 degrees 27 minutes 41 seconds WEST a distance of 800.77 feet;
- 2) SOUTH 89 degrees 35 minutes 25 seconds EAST a distance of 259.76 feet;
- 3) NORTH 00 degrees 18 minutes 12 seconds WEST a distance of 903.90 feet;
- 4) NORTH 89 degrees 35 minutes 51 seconds WEST a distance of 1234.57 feet;
- 5) SOUTH 00 degrees 17 minutes 18 seconds EAST a distance of 900.76 feet to the northeast corner of a parcel in the name of Monroe County Board of Commissioners, as recorded in Instrument Number 2011012445;

thence coincident with the north line of said parcel SOUTH 89 degrees 46 minutes 40 seconds WEST a distance of 633.15 feet to the east line of Parcel 2 as shown on the Acacia Type E Administrative Subdivision Final Plat, as recorded in Plat Cabinet D, Envelope 156; thence coincident with an eastern line of said Parcel 2 SOUTH 01 degrees 24 minutes 06 seconds EAST a distance of 16.86 feet to the southeast corner of said Parcel 2; thence coincident with the south line of said Parcel 2 SOUTH 89 degrees 26 minutes 10 seconds WEST a distance of 404.70 feet to the southwest corner of said Parcel 2; thence coincident with the west line of said Parcel 2 NORTH 00 degrees 24 minutes 33 seconds WEST a distance of 438.51 feet to the northeast corner of Parcel 3 of said Acacia Type E Administrative Subdivision Final Plat; thence coincident with the north line of said Parcel 3 SOUTH 89 degrees 38 minutes 03 seconds WEST a distance of 341.01 feet to the east right of way line of Curry Pike; thence coincident with said east right of way line NORTH 00 degrees 02 minutes 54 seconds WEST a distance of 311.65 feet to the intersection of said east right of way line and the extended north line of a parcel in the name of Acacia Investments LLC and Texin LLC, as recorded in Instrument Number 2013000464; thence coincident with said northern line extended and said northern line SOUTH 89 degrees 59 minutes 13 seconds WEST a distance of 426.11 feet; thence coincident with the lines of said parcel the following 3 courses:

- 1) SOUTH 01 degrees 17 minutes 49 seconds WEST a distance of 815.90 feet;
- 2) SOUTH 00 degrees 57 minutes 51 seconds EAST a distance of 307.76 feet;
- 3) NORTH 89 degrees 59 minutes 58 seconds EAST a distance of 366.88 feet to the western right of way line of Curry Pike;

thence coincident with said west right of way line SOUTH 00 degrees 13 minutes 20 seconds EAST a distance of 471.56 feet to the north right of way line of Vernal Pike; thence coincident with said north right of way line the following 16 courses:

- 1) NORTH 87 degrees 25 minutes 16 seconds WEST a distance of 29.97 feet;
- 2) SOUTH 73 degrees 27 minutes 14 seconds WEST a distance of 50.89 feet;
- 3) SOUTH 00 degrees 00 minutes 20 seconds WEST a distance of 15.14 feet;
- 4) NORTH 89 degrees 42 minutes 37 seconds WEST a distance of 866.49 feet;
- 5) NORTH 00 degrees 19 minutes 32 seconds EAST a distance of 18.40 feet;
- 6) NORTH 87 degrees 37 minutes 37 seconds WEST a distance of 21.42 feet;
- 7) SOUTH 00 degrees 15 minutes 20 seconds EAST a distance of 8.09 feet;
- 8) NORTH 87 degrees 37 minutes 36 seconds WEST a distance of 28.38 feet;
- 9) SOUTH 89 degrees 56 minutes 51 seconds WEST a distance of 310.22 feet;
- 10) SOUTH 87 degrees 03 minutes 20 seconds WEST a distance of 99.85 feet;
- 11) SOUTH 85 degrees 04 minutes 20 seconds WEST a distance of 63.38 feet;
- 12) SOUTH 89 degrees 53 minutes 16 seconds WEST a distance of 416.00 feet;
- 13) NORTH 00 degrees 04 minutes 27 seconds WEST a distance of 13.85 feet;
- 14) SOUTH 89 degrees 39 minutes 00 seconds WEST a distance of 63.19 feet;
- 15) NORTH 69 degrees 21 minutes 00 seconds WEST a distance of 96.57 feet;
- 16) NORTH 89 degrees 47 minutes 23 seconds WEST a distance of 49.80 feet to the east line of a parcel in the name of Clay D. Holmstrom, as recorded in Instrument Number 2012021601;

thence coincident with said east line NORTH 00 degrees 24 minutes 37 seconds WEST a distance of 300.22 feet to the northeast corner of said parcel; thence coincident with the north line of said parcel SOUTH 89 degrees 52 minutes 16 seconds WEST a distance of 362.96 feet to the northeastern right of way line of Loesch Road; thence coincident with said northeastern right of way line NORTH 42 degrees 58 minutes 01 seconds WEST a distance of 276.48 feet to the intersection of said northeastern right of way line and the east line of Section 26, Township 9 North, Range 2 West; thence coincident with said east line SOUTH 00 degrees 47 minutes 37 seconds EAST a distance of 72.32 feet to a northern line of Lot 8 in Northwest Park Subdivision, as

Bledsoe Riggert Cooper James

LAND SURVEYING • CIVIL ENGINEERING • GIS

recorded in Plat Cabinet C, Envelope 146; thence coincident with the northern and western lines of said Lot 8 the following 3 courses:

- 1) NORTH 86 degrees 50 minutes 30 seconds WEST a distance of 65.44 feet;
- 2) SOUTH 35 degrees 43 minutes 10 seconds WEST a distance of 347.45 feet;
- 3) SOUTH 19 degrees 18 minutes 43 seconds WEST a distance of 210.04 feet to the northern right of way line of Vernal Pike;

thence coincident with said northern line the following 5 courses:

- 1) NORTH 81 degrees 10 minutes 06 seconds WEST a distance of 145.16 feet;
- 2) NORTH 69 degrees 18 minutes 34 seconds WEST a distance of 96.34 feet;
- 3) NORTH 57 degrees 43 minutes 53 seconds WEST a distance of 53.61 feet;
- 4) NORTH 57 degrees 43 minutes 52 seconds WEST a distance of 38.30 feet;
- 5) NORTH 47 degrees 07 minutes 45 seconds WEST a distance of 14.32 feet to the intersection of said northern line and the extended western right of way line of Innovation Drive;

thence coincident with said extended western right of way line SOUTH 34 degrees 42 minutes 11 seconds WEST a distance of 172.43 feet to the intersection of said extended western right of way line and the extended south line of Lot 25 of said Northwest Park Subdivision; thence coincident with said extended south line NORTH 89 degrees 04 minutes 12 seconds WEST a distance of 535.44 feet to the southwest corner of said Lot 25 also being the northeast corner to Lot 22 of said Northwest Park Subdivision; thence coincident with the lines of said Lot 22 (with the intent to except said Lot 22 from this description) the following 7 courses:

- 1) SOUTH 06 degrees 12 minutes 14 seconds EAST a distance of 250.00 feet;
- 2) SOUTH 83 degrees 47 minutes 50 seconds WEST a distance of 325.53 feet;
- 3) NORTH 13 degrees 28 minutes 00 seconds EAST a distance of 97.78 feet;
- 4) NORTH 55 degrees 26 minutes 46 seconds EAST a distance of 80.95 feet;
- 5) NORTH 41 degrees 51 minutes 12 seconds EAST a distance of 61.08 feet;
- 6) NORTH 04 degrees 04 minutes 56 seconds EAST a distance of 79.94 feet;
- 7) NORTH 83 degrees 47 minutes 46 seconds EAST a distance of 161.67 feet to said southwest corner of said Lot 25;

thence coincident with the lines of said Northwest Park Subdivision the following 2 courses:

- 1) NORTH 06 degrees 12 minutes 15 seconds WEST a distance of 601.39 feet;
- 2) NORTH 24 degrees 35 minutes 52 seconds WEST a distance of 437.88 feet to the northwest corner of Lot 28 in said Northwest Park Subdivision;

thence coincident with the north line of said Lot 28, and said north line extended NORTH 89 degrees 26 minutes 04 seconds EAST a distance of 668.88 feet to the east right of way line of Vernal Pike; thence coincident with said east right of way line SOUTH 00 degrees 47 minutes 14 seconds EAST a distance of 76.68 feet to the northwest corner of Lot 5 of said Northwest Park Subdivision; thence coincident with the north line of said Northwest Park Subdivision NORTH 89 degrees 04 minutes 16 seconds EAST a distance of 614.97 feet to the eastern line of Lot 4 of said Northwest Park Subdivision; thence coincident with the eastern lines of Lots 4 and 3 of said Northwest Park Subdivision the following 2 courses:

- 1) NORTH 22 degrees 01 minutes 45 seconds WEST a distance of 197.88 feet;
- 2) NORTH 05 degrees 50 minutes 01 seconds EAST a distance of 596.01 feet to the angle point on the southern line of Lot 2 of said Northwest Park Subdivision;

thence coincident with the southern line of said Lot 2 NORTH 82 degrees 04 minutes 24 seconds EAST a distance of 269.13 feet to the eastern right of way line of Loesch Road; thence coincident with the said eastern right of way line NORTH 00 degrees 19 minutes 19 seconds WEST a distance of 355.37 feet to the extended southern line of Lot 1 of said Northwest Park Subdivision; thence coincident with said extended southern line SOUTH 89 degrees 04 minutes 16 seconds WEST a distance of 177.16 feet to the southeast corner of said Lot 1; thence coincident with the eastern lines of said Lot 1 the following 2 courses;

- 1) NORTH 33 degrees 20 minutes 58 seconds WEST a distance of 227.33 feet;
- 2) NORTH 23 degrees 23 minutes 27 seconds WEST a distance of 74.46 feet;

thence coincident with an eastern line of said Lot 1 and said line extended NORTH 31 degrees 43 minutes 44 seconds EAST a distance of 341.56 feet to the northern right of way line of Old Vernal Pike; thence coincident with said northern right of way line the following 9 courses;

- 1) NORTH 70 degrees 12 minutes 22 seconds WEST a distance of 61.39 feet;
- 2) NORTH 84 degrees 08 minutes 44 seconds WEST a distance of 70.08 feet;
- 3) NORTH 89 degrees 46 minutes 18 seconds WEST a distance of 438.78 feet;
- 4) SOUTH 88 degrees 18 minutes 21 seconds WEST a distance of 145.23 feet;
- 5) SOUTH 74 degrees 47 minutes 04 seconds WEST a distance of 72.67 feet;
- 6) SOUTH 67 degrees 06 minutes 19 seconds WEST a distance of 39.95 feet;
- 7) SOUTH 56 degrees 46 minutes 31 seconds WEST a distance of 44.23 feet;
- 8) SOUTH 47 degrees 55 minutes 12 seconds WEST a distance of 43.41 feet;
- 9) SOUTH 45 degrees 00 minutes 27 seconds WEST a distance of 130.47 feet to the southern right of way line of Vernal Pike;

thence leaving said northern line and coincident with said southern right of way line of Vernal Pike the following 4 courses;

- 1) SOUTH 44 degrees 59 minutes 33 seconds EAST a distance of 55.00 feet;
- 2) SOUTH 38 degrees 46 minutes 08 seconds EAST a distance of 100.65 feet;
- 3) SOUTH 30 degrees 11 minutes 55 seconds EAST a distance of 65.44 feet;
- 4) SOUTH 21 degrees 57 minutes 14 seconds EAST a distance of 49.22 feet to a northeast corner of Lot 32 of said Northwest Park Subdivision;

thence coincident with the lines of said Lot 32 the following 2 courses:

- 1) SOUTH 71 degrees 19 minutes 12 seconds WEST a distance of 88.21 feet;
- 2) NORTH 54 degrees 05 minutes 21 seconds WEST a distance of 346.21 feet to a corner of said Lot 32;

thence coincident with an eastern line of said Lot 32 and said line extended NORTH 23 degrees 48 minutes 58 seconds EAST a distance of 250.25 feet to the northern right of way line of Vernal Pike; thence coincident with said northern right of way line the following 2 courses:

- 1) NORTH 89 degrees 45 minutes 37 seconds WEST a distance of 287.30 feet;
- 2) NORTH 77 degrees 25 minutes 57 seconds WEST a distance of 62.34 feet to the extended west line of said Northwest Park Subdivision;

thence coincident with the west line of said Northwest Park Subdivision SOUTH 00 degrees 38 minutes 18 seconds EAST a distance of 1370.62 feet to the northeast corner of Lot 21 of Northwest Park Subdivision as recorded in Survey Cabinet S2, Envelope 35; thence coincident with the lines of said Northwest Park the following 7 courses:

Bledsoe Riggert Cooper James

LAND SURVEYING • CIVIL ENGINEERING • GIS

- 1) NORTH 89 degrees 32 minutes 53 seconds WEST a distance of 781.97 feet;
- 2) SOUTH 00 degrees 39 minutes 47 seconds EAST a distance of 1754.81 feet;
- 3) SOUTH 83 degrees 47 minutes 42 seconds WEST a distance of 23.40 feet;
- 4) SOUTH 00 degrees 00 minutes 01 seconds EAST a distance of 319.38 feet;
- 5) SOUTH 54 degrees 03 minutes 15 seconds WEST a distance of 908.06 feet;
- 6) SOUTH 89 degrees 29 minutes 53 seconds EAST a distance of 471.77 feet to the Northeast corner of the Northwest Quarter of Section 35, Township 9 North, Range 2 West;
- 7) SOUTH 89 degrees 04 minutes 59 seconds EAST a distance of 1784.02 feet to the northeast corner of a parcel in the name of Cook Incorporated, as recorded in Deed Book 462, Page 453;

thence coincident with the east line of said parcel and the east line of a parcel in the name of Cook Incorporated, as recorded in Deed Book 462, Page 451 SOUTH 00 degrees 23 minutes 12 seconds EAST a distance of 2011.71 feet to the northeast corner of Lot 3 of Park 48 Phase 2 as recorded in Plat Cabinet B, Envelope 384; thence coincident with the north line of said Lot 3 SOUTH 89 degrees 22 minutes 12 seconds WEST a distance of 764.96 feet to the east right of way of Daniel's Way; thence coincident with said right of way the following 4 courses:

- 1) NORTH 00 degrees 37 minutes 47 seconds WEST a distance of 613.54 feet to the point of curvature of a curve to the right having a radius of 50.00 feet, a chord bearing of NORTH 25 degrees 56 minutes 07 seconds EAST, and a chord length of 44.72 feet;
- 2) thence along said curve an arc length of 46.36 feet to the point of curvature of a reverse curve to the left having a radius of 50.00 feet, a chord bearing of NORTH 64 degrees 03 minutes 53 seconds WEST, and a chord length of 89.44 feet;
- 3) thence along said curve an arc length of 203.45 feet;
- 4) thence SOUTH 00 degrees 37 minutes 48 seconds EAST a distance of 46.97 feet to the southeast corner of Lot 5 of Park 48 Phase 3 as recorded in Plat Cabinet C, Envelope 127;

thence coincident with the lines of said Lot 5 the following 2 courses:

- 1) NORTH 89 degrees 40 minutes 35 seconds WEST a distance of 950.00 feet;
- 2) NORTH 00 degrees 37 minutes 48 seconds WEST a distance of 80.62 feet to the northeast corner of a parcel in the name of Royce L. and Gena M. Kimble, as recorded in Instrument Number 2004015365;

thence coincident with the north line of said parcel NORTH 89 degrees 34 minutes 21 seconds WEST a distance of 660.00 feet to the northwest corner of said parcel; thence coincident with the west line of said parcel SOUTH 00 degrees 38 minutes 22 seconds EAST a distance of 328.24 feet to the southwest corner of said parcel; thence coincident with the south line of said parcel SOUTH 88 degrees 08 minutes 40 seconds EAST a distance of 638.45 feet to the west right of way line of Knapp Road; thence coincident with said west right of way line the following 11 courses:

- 1) SOUTH 00 degrees 45 minutes 36 seconds EAST a distance of 536.76 feet;
- 2) NORTH 89 degrees 34 minutes 20 seconds WEST a distance of 8.50 feet;
- 3) SOUTH 00 degrees 48 minutes 13 seconds EAST a distance of 462.01 feet;
- 4) SOUTH 89 degrees 34 minutes 26 seconds EAST a distance of 8.50 feet;
- 5) SOUTH 00 degrees 48 minutes 13 seconds EAST a distance of 336.93 feet;
- 6) NORTH 89 degrees 34 minutes 20 seconds WEST a distance of 8.50 feet;
- 7) SOUTH 00 degrees 48 minutes 12 seconds EAST a distance of 110.00 feet;
- 8) SOUTH 89 degrees 34 minutes 26 seconds EAST a distance of 8.50 feet;
- 9) SOUTH 00 degrees 48 minutes 13 seconds EAST a distance of 110.02 feet;
- 10) NORTH 89 degrees 34 minutes 20 seconds WEST a distance of 8.50 feet;
- 11) SOUTH 00 degrees 48 minutes 20 seconds EAST a distance of 110.04 feet to the extended southern line of Lot 2 of Park 48 Phase 1, as recorded in Plat Cabinet B, Envelope 369;

thence coincident with said extended line SOUTH 89 degrees 32 minutes 16 seconds EAST a distance of 352.47 feet to the northwest corner of Lot 1 of Park 48 Phase 1; thence coincident with the west line of said Lot 1 SOUTH 00 degrees 48 minutes 13 seconds EAST a distance of 373.36 feet to the northwest corner of Lot 1B of Park 48 Phase 1, Amendment 1, as recorded in Plat Cabinet C, Envelope 223; thence coincident with the north line of said Lot 1B SOUTH 89 degrees 07 minutes 16 seconds EAST a distance of 366.62 feet to the west right of way line of Daniels Way; thence coincident with said west right of way line SOUTH 01 degrees 03 minutes 21 seconds EAST a distance of 116.06 feet to the northern right of way line of State Road 48; thence coincident with said northern right of way line the following 8 courses:

- 1) NORTH 89 degrees 12 minutes 18 seconds WEST a distance of 14.64 feet;
- 2) SOUTH 01 degrees 15 minutes 58 seconds EAST a distance of 63.86 feet;
- 3) SOUTH 44 degrees 35 minutes 38 seconds WEST a distance of 47.13 feet;
- 4) NORTH 89 degrees 52 minutes 38 seconds WEST a distance of 152.52 feet;
- 5) NORTH 01 degrees 40 minutes 40 seconds WEST a distance of 32.82 feet;
- 6) NORTH 86 degrees 56 minutes 53 seconds WEST a distance of 166.67 feet;
- 7) SOUTH 00 degrees 48 minutes 12 seconds EAST a distance of 68.67 feet;
- 8) NORTH 89 degrees 50 minutes 37 seconds WEST a distance of 1410.33 feet to the intersection of said north right of way line and the extended west line of Fieldstone Boulevard;

thence coincident with said extended west line the following 9 courses:

- 1) SOUTH 01 degrees 05 minutes 33 seconds WEST a distance of 80.72 feet;
- 2) SOUTH 01 degrees 05 minutes 36 seconds WEST a distance of 71.06 feet;
- 3) SOUTH 08 degrees 48 minutes 07 seconds WEST a distance of 101.74 feet;
- 4) SOUTH 16 degrees 42 minutes 13 seconds WEST a distance of 74.13 feet;
- 5) SOUTH 23 degrees 34 minutes 50 seconds WEST a distance of 88.32 feet;
- 6) SOUTH 19 degrees 46 minutes 19 seconds WEST a distance of 103.66 feet;
- 7) SOUTH 13 degrees 25 minutes 56 seconds WEST a distance of 92.78 feet;
- 8) SOUTH 06 degrees 26 minutes 36 seconds WEST a distance of 97.02 feet;
- 9) SOUTH 03 degrees 10 minutes 53 seconds EAST a distance of 13.96 feet to the north right of way line of Stoneview Way;

thence coincident with said north right of way line the following 6 courses:

- 1) NORTH 82 degrees 52 minutes 36 seconds WEST a distance of 20.60 feet;
- 2) thence NORTH 71 degrees 34 minutes 10 seconds WEST a distance of 28.82 feet;
- 3) thence NORTH 62 degrees 51 minutes 24 seconds WEST a distance of 44.64 feet;
- 4) thence NORTH 63 degrees 30 minutes 30 seconds WEST a distance of 90.89 feet;
- 5) thence NORTH 74 degrees 52 minutes 47 seconds WEST a distance of 46.05 feet;

Bledsoe Riggert Cooper James

LAND SURVEYING • CIVIL ENGINEERING • GIS

6) thence NORTH 83 degrees 39 minutes 42 seconds WEST a distance of 35.17 feet to an east line of Stonecrest at Fieldstone phase I, Section I, as recorded in Plat Cabinet C, Envelope 167; thence coincident with said east line and said line extended NORTH 00 degrees 46 minutes 14 seconds EAST a distance of 615.10 feet to the north right of way line of State Road 48; thence coincident with said north right of way line NORTH 89 degrees 23 minutes 49 seconds WEST a distance of 326.15 feet to the extended west line of said Stonecrest at Fieldstone Phase I, Section I; thence coincident with said extended west line SOUTH 00 degrees 00 minutes 00 seconds EAST a distance of 349.04 feet to the northeast corner of Lot 29 of Stonecrest at Fieldstone Phase I, Section II, as recorded in Plat Cabinet C, Envelope 189; thence coincident with the north line of said Stonecrest at Fieldstone Phase I, Section II NORTH 88 degrees 20 minutes 22 seconds WEST a distance of 264.00 feet to the northwest corner of said Stonecrest at Fieldstone Phase I, Section II; thence coincident with the west line of said Stonecrest at Fieldstone Phase I, Section II and Stonecrest at Fieldstone Phase 2, as recorded in Plat Cabinet C, Envelope 243 SOUTH 00 degrees 02 minutes 44 seconds WEST a distance of 900.14 feet to a corner of said Stonecrest at Fieldstone Phase 2; thence coincident with the lines of said Stonecrest at Fieldstone Phase 2 the following 6 courses;

- 1) SOUTH 89 degrees 44 minutes 34 seconds WEST a distance of 256.25 feet;
- 2) SOUTH 00 degrees 02 minutes 46 seconds WEST a distance of 100.20 feet;
- 3) NORTH 89 degrees 48 minutes 31 seconds EAST a distance of 20.93 feet;
- 4) SOUTH 01 degrees 04 minutes 24 seconds WEST a distance of 99.85 feet;
- 5) SOUTH 83 degrees 04 minutes 45 seconds EAST a distance of 28.80 feet;
- 6) SOUTH 00 degrees 01 minutes 02 seconds EAST a distance of 14.98 feet to the northeast corner of a parcel in the name of Erika Marie Robertson, as recorded in Instrument Number 2010016097;

thence coincident with the north line of said parcel and said north line extended NORTH 89 degrees 34 minutes 55 seconds WEST a distance of 264.64 feet to the west right of way line of Kirby Road; thence coincident with said west right of way line SOUTH 01 degrees 13 minutes 57 seconds EAST a distance of 125.74 feet to the north line of Lot 8 of Airport Addition, Section One, as recorded in Survey Book 5, Page 83, or Plat Cabinet B, Envelope 136; thence coincident with said north line NORTH 87 degrees 34 minutes 47 seconds WEST a distance of 304.49 feet to the northwest corner of said Lot 8; thence coincident with the west line of said Airport Addition, Section One SOUTH 00 degrees 41 minutes 01 seconds EAST a distance of 200.00 feet to the southwest corner of Lot 7 of said Airport Addition, Section One, thence coincident with the south line of said Lot 7 SOUTH 87 degrees 34 minutes 47 seconds EAST a distance of 306.44 feet to the said west right of way line of Kirby Road; thence coincident with said west right of way SOUTH 01 degrees 12 minutes 52 seconds EAST a distance of 100.05 feet to the north line of Lot 5 of said Airport Addition, Section One; thence coincident with said north line NORTH 87 degrees 34 minutes 47 seconds WEST a distance of 307.37 feet to the northwest corner of said Lot 5; thence coincident with the west line of said Airport Addition, Section One SOUTH 00 degrees 41 minutes 01 seconds EAST a distance of 100.00 feet to the southwest corner of said Lot 5; thence coincident with the south line of said Lot 5 SOUTH 87 degrees 34 minutes 47 seconds EAST a distance of 308.33 feet to the west right of way of Kirby Road; thence coincident with said right of way the following 3 courses:

- 1) SOUTH 01 degrees 13 minutes 56 seconds EAST a distance of 400.17 feet;
- 2) NORTH 88 degrees 52 minutes 06 seconds EAST a distance of 11.06 feet;
- 3) SOUTH 01 degrees 28 minutes 24 seconds EAST a distance of 2600.65 feet to the south right of way line of Gifford Road;

thence coincident with said south right of way line SOUTH 89 degrees 54 minutes 48 seconds EAST a distance of 3964.53 feet to the west right of way line of Endwright Road; thence coincident with said west right of way line SOUTH 00 degrees 18 minutes 01 seconds EAST a distance of 917.06 feet to the southerly right of way line of the Illinois Central Railroad; thence coincident with said southerly right of way line SOUTH 54 degrees 17 minutes 04 seconds WEST a distance of 754.63 feet to the northern most corner of Karst Farm Subdivision Phase I, as recorded in Plat Cabinet C, Envelope 276; thence coincident with the northwestern line of said Karst Farm Subdivision Phase 1 and Karst Farm Subdivision Phase 2, as recorded in Plat Cabinet C, Envelope 293 SOUTH 54 degrees 13 minutes 03 seconds WEST a distance of 2143.53 feet to the western most corner of said Karst Farm Subdivision Phase 2; thence coincident with the south line of said Karst Farm Subdivision Phase 2 NORTH 89 degrees 53 minutes 21 seconds EAST a distance of 940.00 feet to the southwest corner of Lot 1 of Cornwell Subdivision, as recorded in Plat Cabinet C, Envelope 198; thence coincident with the south line of said Lot 1 NORTH 89 degrees 53 minutes 20 seconds EAST a distance of 1417.21 feet to the west right of way line of Endwright Road; thence coincident with said west right of way line and said line extended SOUTH 00 degrees 04 minutes 32 seconds WEST a distance of 2673.86 feet to the southern line of a parcel in the name of State of Indiana as recorded in Instrument Number 2001001363; thence coincident with said southern line SOUTH 88 degrees 27 minutes 16 seconds EAST a distance of 275.28 feet to point number 70 as shown on the Right of Way Parcel Plat contained in said Instrument; thence continuing coincident with said southern line SOUTH 66 degrees 39 minutes 00 seconds EAST a distance of 169.71 feet point number 69 as shown on said Right of Way Parcel Plat; thence coincident with the right of way for State Road 45 SOUTH 01 degrees 39 minutes 37 seconds WEST a distance of 119.05 feet to point number 63 as shown on said Right of Way Parcel Plat; thence SOUTH 89 degrees 33 minutes 10 seconds EAST a distance of 120.14 feet to the southern right of way line of said State Road 45; thence coincident with said southern right of way the following 19 courses:

- 1) NORTH 49 degrees 42 minutes 08 seconds EAST a distance of 123.25 feet;
- 2) NORTH 56 degrees 05 minutes 05 seconds EAST a distance of 172.53 feet;
- 3) NORTH 47 degrees 07 minutes 15 seconds EAST a distance of 74.60 feet;
- 4) NORTH 89 degrees 51 minutes 48 seconds WEST a distance of 45.78 feet;
- 5) NORTH 47 degrees 41 minutes 00 seconds EAST a distance of 55.04 feet;
- 6) NORTH 53 degrees 11 minutes 00 seconds EAST a distance of 154.51 feet;
- 7) NORTH 48 degrees 18 minutes 00 seconds EAST a distance of 123.50 feet;
- 8) SOUTH 02 degrees 39 minutes 04 seconds EAST a distance of 19.74 feet;
- 9) NORTH 48 degrees 45 minutes 07 seconds EAST a distance of 371.42 feet;
- 10) NORTH 49 degrees 09 minutes 06 seconds WEST a distance of 7.46 feet;
- 11) NORTH 51 degrees 31 minutes 43 seconds EAST a distance of 414.61 feet;
- 12) NORTH 55 degrees 29 minutes 37 seconds EAST a distance of 426.56 feet;
- 13) NORTH 58 degrees 39 minutes 21 seconds EAST a distance of 236.90 feet;
- 14) NORTH 62 degrees 36 minutes 39 seconds EAST a distance of 289.68 feet;
- 15) NORTH 66 degrees 05 minutes 05 seconds EAST a distance of 146.64 feet;
- 16) NORTH 69 degrees 10 minutes 54 seconds EAST a distance of 613.57 feet;
- 17) NORTH 88 degrees 42 minutes 59 seconds EAST a distance of 83.90 feet;
- 18) NORTH 68 degrees 53 minutes 36 seconds EAST a distance of 262.63 feet;
- 19) NORTH 63 degrees 32 minutes 44 seconds EAST a distance of 237.13 feet to the west line of a parcel in the name of Kooshtard, as recorded in Instrument Number 2001017291;

Bledsoe Riggert Cooper James

LAND SURVEYING • CIVIL ENGINEERING • GIS

thence coincident with said west line SOUTH 00 degrees 27 minutes 45 seconds EAST a distance of 141.47 feet to the southwest corner of said parcel; thence coincident with the south line of said parcel NORTH 89 degrees 31 minutes 00 seconds EAST a distance of 190.11 feet to the west line of Ordinance 72-22; thence coincident with said west line NORTH 00 degrees 01 minutes 39 seconds EAST a distance of 274.32 feet to a southwest corner of Ordinance 69-43; thence coincident with said Ordinance 69-43 and the west right of way line of Curry Pike the following 6 courses:

- 1) NORTH 07 degrees 40 minutes 37 seconds WEST a distance of 185.16 feet;
- 2) NORTH 00 degrees 02 minutes 48 seconds EAST a distance of 100.00 feet;
- 3) NORTH 11 degrees 21 minutes 25 seconds EAST a distance of 101.98 feet;
- 4) NORTH 00 degrees 28 minutes 15 seconds WEST a distance of 441.82 feet;
- 5) NORTH 89 degrees 57 minutes 11 seconds WEST a distance of 15.87 feet;
- 6) NORTH 00 degrees 03 minutes 09 seconds WEST a distance of 1711.37 feet to a northwest corner of said Ordinance 69-43;

thence coincident with a northern line of said Ordinance 69-43 NORTH 89 degrees 32 minutes 23 seconds EAST a distance of 293.09 feet to a northeast corner of said Ordinance 69-43; thence coincident with an eastern line of said Ordinance 69-43 SOUTH 00 degrees 00 minutes 00 seconds EAST a distance of 196.20 feet to the northeast corner of Ordinance 70-34; thence coincident with the east line of said Ordinance 70-34 SOUTH 00 degrees 00 minutes 00 seconds EAST a distance of 199.50 feet to the northeast corner of Ordinance 71-31; thence coincident with the east line of said Ordinance 71-31 SOUTH 01 degrees 18 minutes 40 seconds EAST a distance of 108.03 feet to the southeast corner of said Ordinance 71-31; thence coincident with the south line of said Ordinance 71-31 NORTH 89 degrees 59 minutes 57 seconds WEST a distance of 252.61 feet to an eastern line of said Ordinance 69-43; thence coincident with said eastern line SOUTH 00 degrees 28 minutes 02 seconds EAST a distance of 60.61 feet to the northwest corner of Ordinance 73-83; thence coincident with the lines of said Ordinance 73-83 the following 3 courses:

- 1) NORTH 90 degrees 00 minutes 00 seconds EAST a distance of 252.05 feet;
- 2) SOUTH 00 degrees 17 minutes 17 seconds EAST a distance of 198.91 feet;
- 3) SOUTH 89 degrees 31 minutes 01 seconds WEST a distance of 245.57 feet to an eastern line of said Ordinance 69-43 on the east right of way line of Curry Pike;

thence coincident with said Ordinance 69-43 and said east right of way line the following 2 courses:

- 1) SOUTH 00 degrees 11 minutes 14 seconds EAST a distance of 1239.23 feet;
- 2) SOUTH 01 degrees 55 minutes 47 seconds EAST a distance of 299.60 feet to the north right of way line of State Road 45;

thence continuing coincident with said Ordinance 69-43 and coincident with said north right of way line the following 7 courses:

- 1) SOUTH 81 degrees 03 minutes 42 seconds EAST a distance of 54.50 feet;
- 2) NORTH 62 degrees 31 minutes 07 seconds EAST a distance of 112.81 feet;
- 3) NORTH 46 degrees 04 minutes 36 seconds EAST a distance of 579.96 feet;
- 4) NORTH 43 degrees 43 minutes 43 seconds EAST a distance of 69.97 feet;
- 5) NORTH 53 degrees 22 minutes 49 seconds EAST a distance of 202.71 feet;
- 6) NORTH 59 degrees 51 minutes 36 seconds EAST a distance of 78.81 feet;
- 7) NORTH 39 degrees 49 minutes 00 seconds EAST a distance of 86.46 feet to the point of beginning, and containing 3,285.29 acres, more or less.

Excepting therefrom the following:

The area described in Ordinance 74-08, being a part of the Northwest Quarter of Section 12, Township 8 North, Range 2 West, and re-described per Monroe County GIS lines as:

Commencing at the northeast corner of the Northwest Quarter of Section 12, Township 8 North, Range 2 West; thence SOUTH 00 degrees 47 minutes 39 seconds EAST a distance of 573.02 feet to the northeast corner of Ordinance 74-08 and the **Point of Beginning**; thence coincident with the lines of said Ordinance 74-08 the following 4 courses:

- 1) SOUTH 00 degrees 44 minutes 10 seconds EAST a distance of 101.01 feet;
- 2) SOUTH 89 degrees 37 minutes 28 seconds WEST a distance of 1287.77 feet;
- 3) NORTH 00 degrees 41 minutes 19 seconds WEST a distance of 101.00 feet;
- 4) NORTH 89 degrees 37 minutes 28 seconds EAST a distance of 1287.69 feet to the point of beginning, and containing 2.98 acres, more or less;

Also excepting the following:

The area described in Ordinance 73-10, parcels with Tax Identification Numbers 53-04-36-300-003.000-011 and 53-04-36-300-003.005-011, and a portion of Profile Parkway, all a part of Section 36, Township 9 North, Range 2 West and re-described per Monroe County GIS lines as:

Beginning at the southeast corner of said Ordinance 73-10; thence SOUTH 14 degrees 06 minutes 09 seconds WEST a distance of 82.40 feet to the northeast corner of said Tax Parcel Number 53-04-36-300-003.005-011 on the west right of way line of Curry Pike; thence coincident with said west right of way line SOUTH 00 degrees 26 minutes 33 seconds EAST a distance of 1742.95 feet to the north line of Highland Village Second Addition; thence coincident with said north line and the north line of Highland Village Third Addition NORTH 89 degrees 34 minutes 07 seconds WEST a distance of 2601.41 feet to the eastern line of said Profile Parkway; thence coincident with said eastern line and the southern lines of said Profile Parkway the following 4 courses:

- 1) NORTH 00 degrees 31 minutes 18 seconds WEST a distance of 1314.60 feet;
- 2) NORTH 89 degrees 59 minutes 55 seconds EAST a distance of 14.61 feet to the point of curvature of a non-tangent curve to the right having a radius of 405.35 feet, a chord bearing of NORTH 40 degrees 56 minutes 30 seconds EAST, and a chord length of 566.14 feet;
- 3) thence along said curve an arc length of 626.72 feet;
- 4) NORTH 89 degrees 42 minutes 26 seconds EAST a distance of 904.08 feet;

thence NORTH 00 degrees 17 minutes 34 seconds WEST a distance of 66.20 feet to the southwest corner of said Ordinance 73-10; thence coincident with the lines of said Ordinance the following 12 courses:

- 1) NORTH 27 degrees 09 minutes 17 seconds EAST a distance of 3.25 feet to the point of curvature of a curve to the right having a radius of 385.39 feet, a chord bearing of NORTH 41 degrees 17 minutes 00 seconds EAST, and a chord length of 188.15 feet;
- 2) Northerly along said curve a distance of 190.07 feet;
- 3) NORTH 57 degrees 57 minutes 12 seconds EAST a distance of 199.99 feet;

Bledsoe Riggert Cooper James

LAND SURVEYING • CIVIL ENGINEERING • GIS

- 4) NORTH 62 degrees 39 minutes 26 seconds EAST a distance of 381.91 feet;
- 5) NORTH 00 degrees 03 minutes 01 seconds WEST a distance of 22.47 feet;
- 6) SOUTH 89 degrees 20 minutes 01 seconds EAST a distance of 34.59 feet;
- 7) NORTH 56 degrees 17 minutes 34 seconds EAST a distance of 417.02 feet;
- 8) NORTH 59 degrees 20 minutes 41 seconds EAST a distance of 120.96 feet;
- 9) NORTH 69 degrees 42 minutes 27 seconds EAST a distance of 83.53 feet;
- 10) NORTH 83 degrees 47 minutes 22 seconds EAST a distance of 70.80 feet;
- 11) SOUTH 90 degrees 00 minutes 00 seconds EAST a distance of 56.73 feet;
- 12) SOUTH 00 degrees 22 minutes 47 seconds EAST a distance of 787.40 feet to the point of beginning, and containing 119.77 acres, more or less.